

# Laboratory Equipment

October 2011



## Features & Benefits

### Brass Construction

Extremely smooth hand and machine polished cast brass construction

### Interchangeable

Interchangeable and versatile spout design allows for easy on-site conversion

### Finishes

Satin antimicrobial or polished chrome available

### Extra Durability

Heavy nickel plate under chrome plating for extra durability and high luster finish

### Versatile

Durable, solid brass hose ends with ten serrations to firmly hold a variety of hose sizes



### Unsurpassed Quality

Every product is made to exacting standards using only the finest materials. And each product is made to order, inspected, and tested before it leaves the factory.



### Commitment To Innovation

From state-of-the-art robotics to constant product development, Chicago Faucets has been a proven leader in product innovation for over 100 years.



### Design Synergy

A belief in performance and interchangeable components has driven Chicago Faucets since its inception. This provides unmatched flexibility for product configurations, updates, and repair.



### Customer Support

The only thing stronger than our products are the employees that are there to support you. From order entry to installation advice, you can count on quality support anytime.



Chemical resistant satin antimicrobial coating inhibits the growth of odor- and stain-causing bacteria, molds, mildew, and fungi.

# Satin Antimicrobial, Chemical

Introducing a new line of satin laboratory products from Chicago Faucets featuring **Sureshield® Silver Ion Technology**.

Sureshield utilizes a compound encapsulated in a glass matrix to form an antimicrobial barrier. When exposed to moisture, the glass “dissolves”, releasing compounds that cause a repression of metabolic functions in microbes and bacterium.

## A Multi-Level Approach for Increased Chemical Resistance

After the Chicago Faucets solid metal product is nickel and chrome plated, an extremely durable glass matrix coating is applied as a final step. The compounds are incorporated as an integral part of the glass matrix and provide additional heat and chemical resistance. The glass matrix also reduces the growth of odor- and stain-causing bacteria, molds, mildews, and fungi on the coating.



- Sureshield antimicrobial coating
- Durable chrome plate
- Bright nickel plate



# Resistant Laboratory Products

## The Antimicrobial Glass Matrix Process

The antimicrobial compound glass matrix provides a consistent dissolution rate at all levels of ambient moisture. This consistent release helps to effectively maintain an antimicrobial surface that provides an additional level of protection and durability to your Chicago Faucets.

Other manufacturers use a ceramic matrix where the rate of silver ions released is directly related to the amount of moisture present. When the moisture is lower, the release rate will also be lower, resulting in less antimicrobial activity. If the moisture is abundant, a large amount of silver can be released and can result in discoloration to the product.

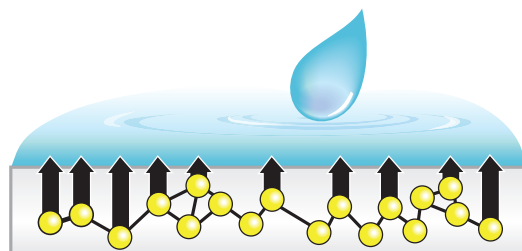

*The glass matrix provides a consistent release of antimicrobial compounds, regardless of the amount of moisture present.*

## A Visible Difference

The antimicrobial coating inhibits the growth of odor- and stain-causing bacteria, molds, mildews, and fungi. In addition, the coating is designed to resist fingerprints for the life of the product.

Untreated

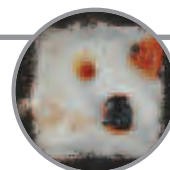

Sureshield

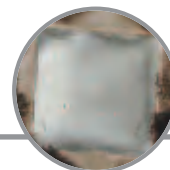

Sureshield coatings are submitted to a series of tests; before, during, and after production, to ensure superior quality. Images above give visual reference to a 28-day dried film fungal test (ASTM G 21-96). The untreated sample shows significant fungal growth and rust formation, while the Sureshield sample remains virtually unchanged.

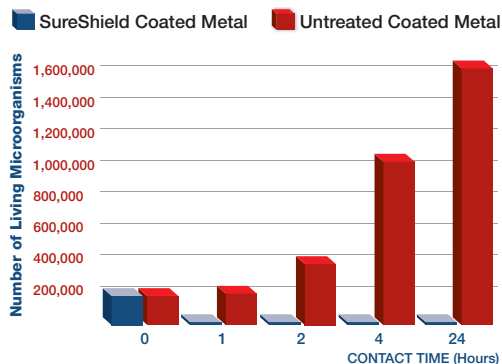

By controlling the chemical make-up of the glass matrix, the Sureshield coating can accurately control the dissolution rate to provide consistent delivery of antimicrobial compounds to the product surface. The result is dependable, effective, and consistent antimicrobial activity on the coated surface.

In a 24-hour surface test, the number of living microorganisms on a piece of metal with the antimicrobial coating were immeasurable by standard laboratory equipment. The number of microorganisms still living on an untreated metal surface rose substantially under identical conditions.

# CHICAGO FAUCETS UNSURPASSED QUALITY

## Exceptional Quality Since 1901

When Chicago Faucets was established, Teddy Roosevelt had just taken office as the 26th President, there were no automobiles, and women couldn't vote. While a lot has changed over the last 100+ years, one thing has remained constant: the quality of the faucets we manufacture.

For an entire century, every faucet that bears the Chicago Faucets name has been built with a specific customer in mind. A constant commitment to the latest technology combined with our hand-crafted quality is, and always will be, the heart and soul of this company. That same passion can be found in all of our faucets and fixtures for laboratory applications.

## A Commitment To Water Conservation and Sustainability

Sustainability and social responsibility are closely interrelated and are important subjects for us. Chicago Faucets has shown that economic success, acting in an environmentally friendly manner, and social balance are not mutually exclusive. On the contrary, we regard sustainability as an opportunity to travel down new roads. Our goal is to be a role model for the industry in sustainability and conservation through ongoing environmental initiatives throughout our company.



Chicago Faucets is a member of the U.S. Green Building Council. USGBC has developed The Leadership in Energy and Environmental Design (LEED) Green Building Rating System™.



Chicago Faucets is an executive member of The Scientific Equipment and Furniture Association, an organization dedicated to establishing standards for safe and effective laboratory environments.



We are proud to be a partner with WaterSense, a program sponsored by the EPA, designed to protect the future of our nation's water supply.



Chicago Faucets is a charter sponsor of the Alliance for Water Efficiency, a non-profit organization that is dedicated to the efficient and sustainable use of water.

## TABLE OF CONTENTS

Features & Benefits	2
Introducing Our SAM™ Products With SureShield®	3-4
Table of Contents	5
Satin Antimicrobial Lab Products	6-9
Standard Lab Products	10-31
Warranty	32-33
Product Specifications	34-35
Product Index	36

## Satin Antimicrobial Products

Combination Fittings	6
Water Fittings	6-7
Remote Control Fittings	7-8
Turrets	8-9
Valves & Flanges	9

## Standard Lab Products

Combination Fittings	10
Water Fittings	10-17
Remote Control Fittings	18-19
Turrets	19-24
Valves & Flanges	25-27
Accessories	28-29
Safety	30-31

# COMBINATION FITTINGS / WATER FITTINGS



Chemical resistant satin antimicrobial coating inhibits the growth of odor- and stain-causing bacteria, molds, mildew, and fungi.

All Satin Antimicrobial Turrets & Flanges Are Fully Assembled And Ready For Installation

## Multiple Service Fittings



BUY  
AMERICAN  
ACT  
COMPLIANT

### 1301-WSVGN2BVB E7SAM

- Deck Mounted Multiple Service Fitting
- GN2BVB Rigid/Swing Atmospheric Vacuum Breaker Gooseneck Spout\*
- E7 Removable Serrated Hose Nozzle
- 204 Cross Handle with Cold Water Service Button
- Slow Compression Operating Cartridge
- (2) 909 Ball Valves @ 180°
- (3) 3/8" NPT Male Inlet Shanks Assembled



BUY  
AMERICAN  
ACT  
COMPLIANT

### 1301-WSVSAM

- Deck Mounted Multiple Service Fitting
- GN2B Rigid/Swing Gooseneck Spout
- E7 Removable Serrated Hose Nozzle
- 204 Cross Handle with Cold Water Service Button
- Slow Compression Operating Cartridge
- (2) 909 Ball Valves @ 180°
- (3) 3/8" NPT Male Inlet Shanks Assembled



BUY  
AMERICAN  
ACT  
COMPLIANT

### 1332-E22E7SAM

- One Piece Cast Brass Spout
- E22 Inline Vacuum Breaker\*
- E7T Removable Serrated Hose Nozzle
- 205 Plastic Cross Handle with Cold Water Service Button
- Slow Compression Operating Cartridge
- (2) 909C Ball Valves with Checks
- (2) 3/8" NPT Male Inlet Shank Assemblies

## WATER FITTINGS - Deck Mounted



BUY  
AMERICAN  
ACT  
COMPLIANT

### 1332-SAM

- One Piece Cast Brass Spout
- E7 Removable Serrated Hose Nozzle
- 205 Plastic Cross Handle with Cold Water Service Button
- Slow Compression Operating Cartridge
- (2) 909C Ball Valves with Checks
- (2) 3/8" NPT Male Inlet Shank Assemblies



BUY  
AMERICAN  
ACT  
COMPLIANT

### 927-SAM

- Single Inlet Water Fitting
- GN2B Rigid/Swing Gooseneck Spout
- E7 Removable Serrated Hose Nozzle
- 204 Cross Handle with Cold Water Service Button
- Slow Compression Operating Cartridge
- 1/2" NPSM Coupling Nut for 3/8" or 1/2" Flexible Riser



BUY  
AMERICAN  
ACT  
COMPLIANT

### 928-317SAM

- Single Inlet Water Fitting
- GN2BVB Rigid/Swing Atmospheric Vacuum Breaker Gooseneck Spout\*
- E7 Removable Serrated Hose Nozzle
- 317 Cold Indexed Wristblade Handle
- Quatum™ Operating Cartridge
- 1/2" NPSM Coupling Nut for 3/8" or 1/2" Flexible Riser



BUY  
AMERICAN  
ACT  
COMPLIANT

### 928-VRSAM

- Vandal Resistant Single Inlet Water Fitting
- GN2BVB Rigid Only Atmospheric Vacuum Breaker Gooseneck Spout\*
- E7 Serrated Hose Nozzle
- 204 Cross Handle with Cold Water Service Button
- Slow Compression Operating Cartridge
- Anti-Rotational Body Deck Pin
- 1/2" NPSM Coupling Nut for 3/8" or 1/2" Flexible Riser
- All Threaded Connections Cemented



BUY  
AMERICAN  
ACT  
COMPLIANT

### 929-SAM

- Combination Hot and Cold Water Fitting
- GN2B Rigid/Swing Gooseneck Spout
- E7 Removable Serrated Hose Nozzle
- 204 Cross Handles with Hot and Cold Water Service Buttons
- Slow Compression Operating Cartridges
- 3/8" O.D. Copper Supply Tubes



BUY  
AMERICAN  
ACT  
COMPLIANT

### 930-317SAM

- Combination Hot and Cold Water Fitting
- GN2BVB Rigid/Swing Atmospheric Vacuum Breaker Gooseneck Spout\*
- E7 Removable Serrated Hose Nozzle
- 317 Indexed Wristblade Handles
- Quatum™ Operating Cartridges
- 3/8" O.D. Copper Supply Tubes

# WATER FITTINGS / REMOTE CONTROLLED FITTINGS

**CHICAGO  
FAUCETS**

a Geberit company

**SAM**  
satin antimicrobial

Chemical resistant satin antimicrobial coating inhibits the growth of odor- and stain-causing bacteria, molds, mildew, and fungi.

All Satin Antimicrobial Turrets & Flanges Are Fully Assembled And Ready For Installation

## Deck Mounted



BUY  
AMERICAN  
ACT  
COMPLIANT

### 930-SAM

- Combination Hot and Cold Water Fitting
- GN2BVB Rigid/Swing Atmospheric Vacuum Breaker Gooseneck Spout\*
- E7 Removable Serrated Hose Nozzle
- 204 Cross Handles with Hot and Cold Water Service Buttons
- Slow Compression Operating Cartridges
- 3/8" O.D. Copper Supply Tubes



BUY  
AMERICAN  
ACT  
COMPLIANT

### 930-VR317SAM

- Vandal Resistant Combination Hot and Cold Water Fitting
- GN2BVB Rigid Only Atmospheric Vacuum Breaker Gooseneck Spout\*
- E7 Removable Serrated Hose Nozzle
- 317 Indexed Wristblade Handles
- Quatum™ Operating Cartridges
- Anti-Rotational Body Deck Pin
- 3/8" O.D. Copper Supply Tubes
- All Threaded Connections Cemented



BUY  
AMERICAN  
ACT  
COMPLIANT

### 930-VRSAM

- Vandal Resistant Combination Hot and Cold Water Fitting
- GN2BVB Rigid Only Atmospheric Vacuum Breaker Gooseneck Spout\*
- E7 Removable Serrated Hose Nozzle
- 204 Cross Handles with Hot and Cold Water Service Buttons
- Slow Compression Operating Cartridges
- Anti-Rotational Body Deck Pin
- 3/8" O.D. Copper Supply Tubes
- All Threaded Connections Cemented

## Pure Water Fittings



BUY  
AMERICAN  
ACT  
COMPLIANT

### 828-ASAM

- Deck Mounted Pure Water Fitting
- Polypropylene Valve Body Assembly
- PTFE Liner with Chrome Plated Brass Housing
- Serrated Hose Nozzle
- 3-Arm Polypropylene Handle
- Polypropylene Cartridge with PTFE Seat
- 3/8" NPT Polypropylene Male Inlet



BUY  
AMERICAN  
ACT  
COMPLIANT

### 969-SAM

- Deck Mounted Distilled Water Fitting
- All Internal Surfaces Are Tin Lined
- GN2B Rigid/Swing Gooseneck Spout
- E7 Removable Serrated Hose Nozzle
- 204 Cross Handle with DW Service Button
- Self-Closing Cartridge
- 1/4" NPT Male Inlet Tailpiece

## REMOTE CONTROLLED FITTINGS - Panel Mounted



BUY  
AMERICAN  
ACT  
COMPLIANT

### 913-AGVSAM

- Right-Hand 45° Angle Control Valve
- 204 Cross Handle with Air, Gas And Vacuum Service Buttons
- Needle Valve Cartridge
- 3/8" NPT Female Inlet and Outlet



BUY  
AMERICAN  
ACT  
COMPLIANT

### 913-LHAGVSAM

- Left-Hand 45° Angle Control Valve
- 204 Cross Handle with Air, Gas And Vacuum Service Buttons
- Needle Valve Cartridge
- 3/8" NPT Female Inlet and Outlet



BUY  
AMERICAN  
ACT  
COMPLIANT

### 914-SAM

- Right-Hand 45° Angle Control Water Valve
- 204 Cross Handle with Cold Water Service Button
- Slow Compression Operating Cartridge
- 3/8" NPT Female Inlet and Outlet

# REMOTE CONTROLLED FITTINGS / TURRETS



Chemical resistant satin antimicrobial coating inhibits the growth of odor- and stain-causing bacteria, molds, mildew, and fungi.

All Satin Antimicrobial Turrets & Flanges Are Fully Assembled And Ready For Installation

## Wall / Panel Mounted



### 962-VOSAM

- Remote Control Water Valve for Straight Panels
- Wall Flange and Extension Rod
- 204 Cross Handle with Cold Water Service Button
- Slow Compression Operating Cartridge
- 3/8" NPT Female Inlet and Outlet



### 1322-AGVSAM

- Control Valve with Threaded Flange
- 204 Cross Handle with Air, Gas And Vacuum Service Buttons
- Needle Valve Cartridge
- 3/8" NPT Female Inlet and Outlet



### 1323-SAM

- Control Valve with Threaded Flange
- 204 Cross Handle with Cold Water Service Button
- Slow Compression Operating Cartridge
- 3/8" NPT Female Inlet and Outlet

## TURRETS - Combo Valve & Turret



### 980-VR909CAGSAM

- Vandal Resistant Turret with Single Ball Valve
- E7TC Serrated Hose Nozzle with Check
- Lever Handle with Air and Gas Service Buttons
- Vandal Resistant Pin in Turret
- All Threaded Connections Cemented
- 3/8" NPT Inlet Shank Assembled



### 980-WSV909AGVSAM

- Turret with Single Ball Valve
- E7T Removable Serrated Hose Nozzle
- Lever Handle with Air, Gas and Vac Service Buttons
- 3/8" NPT Inlet Shank Assembled



### 980-WSV909CAGSAM

- Turret with Single Ball Valve
- E7TC Removable Serrated Hose Nozzle with Check
- Lever Handle with Air and Gas Service Buttons
- 3/8" NPT Inlet Shank Assembled



### 980-WSV937CHAGVSAM

- Turret with Single Needle Valve
- E7 Removable Serrated Hose Nozzle
- 204 Cross Handle with Air, Gas and Vac Service Buttons
- Needle Valve Cartridge
- 3/8" NPT Inlet Shank Assembled



### 981-VR909CAGSAM

- Vandal Resistant Turret with Two Ball Valves @ 180°
- E7TC Serrated Hose Nozzle with Check
- Lever Handles with Air and Gas Service Buttons
- Vandal Resistant Pin in Turret
- All Threaded Connections Cemented
- 3/8" NPT Inlet Shank Assembled



### 981-WSV909AGVSAM

- Turret with Two Ball Valves @ 180°
- E7T Removable Serrated Hose Nozzle
- Lever Handles with Air, Gas and Vac Service Buttons
- 3/8" NPT Inlet Shank Assembled



# TURRETS / VALVES & FLANGES

**CHICAGO  
FAUCETS**

a Geberit company

**SAM**  
satin antimicrobial

Chemical resistant satin antimicrobial coating inhibits the growth of odor- and stain-causing bacteria, molds, mildew, and fungi.

All Satin Antimicrobial Turrets & Flanges Are Fully Assembled And Ready For Installation

## Combo Valve & Turret



BUY  
AMERICAN  
ACT  
COMPONENT

### 982-VR909CAGSAM

- Vandal Resistant Turret with Two Ball Valves @ 90°
- E7TC Serrated Hose Nozzles with Check
- Lever Handles with Air and Gas Service Buttons
- Vandal Resistant Pin in Turret
- All Threaded Connections Cemented
- 3/8" NPT Inlet Shank Assembled



BUY  
AMERICAN  
ACT  
COMPONENT

### 982-WSV909AGVSAM

- Turret with Two Ball Valves @ 90°
- E7T Removable Serrated Hose Nozzle
- Lever Handles with Air, Gas and Vac Service Buttons
- 3/8" NPT Inlet Shank Assembled



BUY  
AMERICAN  
ACT  
COMPONENT

### 980-WSGN2BE7SAM

- Turret with Spout
- GN2B Rigid/Swing Gooseneck Spout
- E7 Removable Serrated Hose Nozzle
- 3/8" NPT Inlet Shank Assembled

## VALVES & FLANGES - Combo Valve & Flange



BUY  
AMERICAN  
ACT  
COMPONENT

### 980-WSGN2BVB7SAM

- Turret with Spout
- GN2BVB Rigid/Swing Atmospheric Vacuum Breaker Gooseneck Spout\*
- E7 Removable Serrated Hose Nozzle
- 3/8" NPT Inlet Shank Assembled

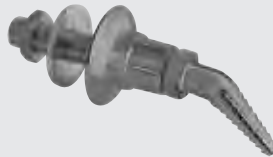

BUY  
AMERICAN  
ACT  
COMPONENT

### 986-WSE7XTSAM

- Wall Flange with Serrated Hose Nozzle
- E7XT 30° Removable Angled Serrated Hose Nozzle
- 3/8" NPT Inlet Shank Assembled



BUY  
AMERICAN  
ACT  
COMPONENT

### 986-WSV909AGVSAM

- Wall Flange with Ball Valve
- E7T Removable Serrated Hose Nozzle
- Lever Handle with Air, Gas and Vac Service Buttons
- 3/8" NPT Inlet Shank Assembled



BUY  
AMERICAN  
ACT  
COMPONENT

### 986-WSV937CHAGVSAM

- Wall Flange with Needle Valve
- E7 Removable Serrated Hose Nozzle
- 204 Cross Handle with Air, Gas and Vac Service Buttons
- Needle Valve Cartridge
- 3/8" NPT Inlet Shank Assembled

# COMBINATION FITTINGS / WATER FITTINGS



## Multiple Service Fittings



BUY  
AMERICAN  
ACT  
COMPLIANT

### 1301-CP

- Deck Mounted Multiple Service Fitting
- GN2B Rigid/Swing Gooseneck Spout
- E7 Removable Serrated Hose Nozzle
- 204 Cross Handle with Cold Water Service Button
- Slow Compression Operating Cartridge
- (2) 909 Ball Valves @ 180°
- 1301-SB1K Inlet Shank Assembly - Shipped Loose



BUY  
AMERICAN  
ACT  
COMPLIANT



### 1301-GN2BVBE7-369CP

- Deck Mounted Multiple Service Fitting
- GN2BVB Rigid/Swing Atmospheric Vacuum Breaker Gooseneck Spout\*
- E7 Removable Serrated Hose Nozzle
- 369 Cold Indexed Lever Handle
- Quatum™ Operating Cartridge
- (2) 909 Ball Valves @ 180°
- 1301-SB1K Inlet Shank Assembly - Shipped Loose



BUY  
AMERICAN  
ACT  
COMPLIANT

### 1301-GN2BVBE7CP

- Deck Mounted Multiple Service Fitting
- GN2BVB Rigid/Swing Atmospheric Vacuum Breaker Gooseneck Spout\*
- E7 Removable Serrated Hose Nozzle
- 204 Cross Handle with Cold Water Service Button
- Slow Compression Operating Cartridge
- (2) 909 Ball Valves @ 180°
- 1301-SB1K Inlet Shank Assembly - Shipped Loose

## Dual Service Fittings



BUY  
AMERICAN  
ACT  
COMPLIANT

### 1332-CP

- One Piece Cast Brass Spout
- E7 Removable Serrated Hose Nozzle
- 205 Plastic Cross Handle with Cold Water Service Button
- Slow Compression Operating Cartridge
- (2) 909C Ball Valves with Checks
- (2) 3/8" NPT Male Inlet Shank Assemblies



BUY  
AMERICAN  
ACT  
COMPLIANT

### 1332-E22E7CP

- One Piece Cast Brass Spout
- E22 Inline Vacuum Breaker\*
- E7T Removable Serrated Hose Nozzle
- 205 Plastic Cross Handle with Cold Water Service Button
- Slow Compression Operating Cartridge
- (2) 909C Ball Valves with Checks
- (2) 3/8" NPT Male Inlet Shank Assemblies

## WATER FITTINGS - Deck Mounted



BUY  
AMERICAN  
ACT  
COMPLIANT



### 927-317CP

- Single Inlet Water Fitting
- GN2B Rigid/Swing Gooseneck Spout
- E7 Removable Serrated Hose Nozzle
- 317 Cold Indexed Wristblade Handle
- Quatum™ Operating Cartridge
- 1/2" NPSM Coupling Nut for 3/8" or 1/2" Flexible Riser



BUY  
AMERICAN  
ACT  
COMPLIANT

### 927-CP

- Single Inlet Water Fitting
- GN2B Rigid/Swing Gooseneck Spout
- E7 Removable Serrated Hose Nozzle
- 204 Cross Handle with Cold Water Service Button
- Slow Compression Operating Cartridge
- 1/2" NPSM Coupling Nut for 3/8" or 1/2" Flexible Riser



BUY  
AMERICAN  
ACT  
COMPLIANT

### 927-VPPCP

- Single Inlet Water Fitting
- GN2B Rigid/Swing Gooseneck Spout
- E7 Removable Serrated Hose Nozzle
- 204 Cross Handle with Cold Water Service Button
- Slow Compression Operating Cartridge
- Anti-Rotational Body Deck Pin
- 1/2" NPSM Coupling Nut for 3/8" or 1/2" Flexible Riser

## Deck Mounted



### 928-317CP

- Single Inlet Water Fitting
- GN2BVB Rigid/Swing Atmospheric Vacuum Breaker Gooseneck Spout\*
- E7 Removable Serrated Hose Nozzle
- 317 Cold Indexed Wristblade Handle
- Quatum™ Operating Cartridge
- 1/2" NPSM Coupling Nut for 3/8" or 1/2" Flexible Riser



### 928-369CP

- Single Inlet Water Fitting
- GN2BVB Rigid/Swing Atmospheric Vacuum Breaker Gooseneck Spout\*
- E7 Removable Serrated Hose Nozzle
- 369 Cold Indexed Lever Handle
- Quatum™ Operating Cartridge
- 1/2" NPSM Coupling Nut for 3/8" or 1/2" Flexible Riser



### 928-CP

- Single Inlet Water Fitting
- GN2BVB Rigid/Swing Atmospheric Vacuum Breaker Gooseneck Spout\*
- E7 Removable Serrated Hose Nozzle
- 204 Cross Handle with Cold Water Service Button
- Slow Compression Operating Cartridge
- 1/2" NPSM Coupling Nut for 3/8" or 1/2" Flexible Riser



### 928-GN8BVB E7CP

- Single Inlet Water Fitting
- GN8BVB Rigid/Swing Atmospheric Vacuum Breaker Gooseneck Spout\*
- E7 Removable Serrated Hose Nozzle
- 204 Cross Handle with Cold Water Service Button
- Slow Compression Operating Cartridge
- 1/2" NPSM Coupling Nut for 3/8" or 1/2" Flexible Riser



### 928-VR317CP

- Vandal Resistant Single Inlet Water Fitting
- GN2BVB Rigid Only Atmospheric Vacuum Breaker Gooseneck Spout\*
- E7 Serrated Hose Nozzle
- 317 Cold Indexed Wristblade Handle
- Quatum™ Operating Cartridge
- Anti-Rotational Body Deck Pin
- 1/2" NPSM Coupling Nut for 3/8" or 1/2" Flexible Riser
- All Threaded Connections Cemented



### 928-VR369CP

- Vandal Resistant Single Inlet Water Fitting
- GN2BVB Rigid Only Atmospheric Vacuum Breaker Gooseneck Spout\*
- E7 Serrated Hose Nozzle
- 369 Cold Indexed Lever Handle
- Quatum™ Operating Cartridge
- Anti-Rotational Body Deck Pin
- 1/2" NPSM Coupling Nut for 3/8" or 1/2" Flexible Riser
- All Threaded Connections Cemented



### 928-VRCP

- Vandal Resistant Single Inlet Water Fitting
- GN2BVB Rigid Only Atmospheric Vacuum Breaker Gooseneck Spout\*
- E7 Serrated Hose Nozzle
- 204 Cross Handle with Cold Water Service Button
- Slow Compression Operating Cartridge
- Anti-Rotational Body Deck Pin
- 1/2" NPSM Coupling Nut for 3/8" or 1/2" Flexible Riser
- All Threaded Connections Cemented



### 928-VRE3-2CP

- Vandal Resistant Single Inlet Water Fitting
- GN2BVB Rigid Only Atmospheric Vacuum Breaker Gooseneck Spout\*
- E3-2, 2.2 GPM Pressure Compensating Softflo® Aerator
- 204 Cross Handle with Cold Water Service Button
- Slow Compression Operating Cartridge
- Anti-Rotational Body Deck Pin
- 1/2" NPSM Coupling Nut for 3/8" or 1/2" Flexible Riser
- All Threaded Connections Cemented



### 928-VRLHCP

- Vandal Resistant Single Inlet Water Fitting Left Hand Operation
- GN2BVB Rigid Only Atmospheric Vacuum Breaker Gooseneck Spout\*
- E7 Serrated Hose Nozzle
- 204 Cross Handle with Cold Water Service Button
- Slow Compression Operating Cartridge
- Anti-Rotational Body Deck Pin
- 1/2" NPSM Coupling Nut for 3/8" or 1/2" Flexible Riser
- All Threaded Connections Cemented

# WATER FITTINGS

## Deck Mounted



BUY  
AMERICAN  
ACT  
COMPLIANT

### 929-317CP

- Combination Hot and Cold Water Fitting
- GN2B Rigid/Swing Gooseneck Spout
- E7 Removable Serrated Hose Nozzle
- 317 Cold Indexed Wristblade Handles
- Quatum™ Operating Cartridges
- 3/8" O.D. Copper Supply Tubes



BUY  
AMERICAN  
ACT  
COMPLIANT

### 929-CP

- Combination Hot and Cold Water Fitting
- GN2B Rigid/Swing Gooseneck Spout
- E7 Removable Serrated Hose Nozzle
- 204 Cross Handles with Hot and Cold Water Service Buttons
- Slow Compression Operating Cartridges
- 3/8" O.D. Copper Supply Tubes



BUY  
AMERICAN  
ACT  
COMPLIANT

### 930-317CP

- Combination Hot and Cold Water Fitting
- GN2BVB Rigid/Swing Atmospheric Vacuum Breaker Gooseneck Spout\*
- E7 Removable Serrated Hose Nozzle
- 317 Cold Indexed Wristblade Handles
- Quatum™ Operating Cartridges
- 3/8" O.D. Copper Supply Tubes



BUY  
AMERICAN  
ACT  
COMPLIANT

### 930-369CP

- Combination Hot and Cold Water Fitting
- GN2BVB Rigid/Swing Atmospheric Vacuum Breaker Gooseneck Spout\*
- E7 Removable Serrated Hose Nozzle
- 369 Indexed Lever Handles
- Quatum™ Operating Cartridges
- 3/8" O.D. Copper Supply Tubes



BUY  
AMERICAN  
ACT  
COMPLIANT

### 930-CP

- Combination Hot and Cold Water Fitting
- GN2BVB Rigid/Swing Atmospheric Vacuum Breaker Gooseneck Spout\*
- E7 Removable Serrated Hose Nozzle
- 204 Cross Handles with Hot and Cold Water Service Buttons
- Slow Compression Operating Cartridges
- 3/8" O.D. Copper Supply Tubes



BUY  
AMERICAN  
ACT  
COMPLIANT

### 930-GN8BVBE7-317CP

- Combination Hot and Cold Water Fitting
- GN8BVB Rigid/Swing Atmospheric Vacuum Breaker Gooseneck Spout\*
- E7 Removable Serrated Hose Nozzle
- 317 Indexed Wristblade Handles
- Quatum™ Operating Cartridges
- 3/8" O.D. Copper Supply Tubes



BUY  
AMERICAN  
ACT  
COMPLIANT

### 930-GN8BVBE7CP

- Combination Hot and Cold Water Fitting
- GN8BVB Rigid/Swing Atmospheric Vacuum Breaker Gooseneck Spout\*
- E7 Removable Serrated Hose Nozzle
- 204 Cross Handles with Hot and Cold Water Service Buttons
- Slow Compression Operating Cartridges
- 3/8" O.D. Copper Supply Tubes



BUY  
AMERICAN  
ACT  
COMPLIANT

### 930-VR317CP

- Vandal Resistant Combination Hot and Cold Water Fitting
- GN2BVB Rigid Only Atmospheric Vacuum Breaker Gooseneck Spout\*
- E7 Serrated Hose Nozzle
- 317 Indexed Wristblade Handles
- Quatum™ Operating Cartridges
- Anti-Rotational Body Deck Pin
- 3/8" O.D. Copper Supply Tubes
- All Threaded Connections Cemented



BUY  
AMERICAN  
ACT  
COMPLIANT

### 930-VR369CP

- Vandal Resistant Combination Hot and Cold Water Fitting
- GN2BVB Rigid Only Atmospheric Vacuum Breaker Gooseneck Spout\*
- E7 Serrated Hose Nozzle
- 369 Indexed Lever Handles
- Quatum™ Operating Cartridges
- Anti-Rotational Body Deck Pin
- 3/8" O.D. Copper Supply Tubes
- All Threaded Connections Cemented

## Deck Mounted



BUY  
AMERICAN  
ACT  
COMPLIANT

### 930-VRCP

- Vandal Resistant Combination Hot and Cold Water Fitting
- GN2BVB Rigid Only Atmospheric Vacuum Breaker Gooseneck Spout\*
- E7 Serrated Hose Nozzle
- 204 Cross Handles with Hot and Cold Water Service Buttons
- Slow Compression Operating Cartridges
- Anti-Rotational Body Deck Pin
- 3/8" O.D. Copper Supply Tubes
- All Threaded Connections Cemented



BUY  
AMERICAN  
ACT  
COMPLIANT

### 930-XKCP

- Combination Hot and Cold Water Fitting
- GN2BVB Rigid/Swing Atmospheric Vacuum Breaker Gooseneck Spout\*
- E7 Removable Serrated Hose Nozzle
- 204 Cross Handles with Hot and Cold Water Service Buttons
- Ceramic Disc Operating Cartridges
- 3/8" O.D. Copper Supply Tubes



BUY  
AMERICAN  
ACT  
COMPLIANT

### 931-L12CP

- Combination Hot and Cold Water Fitting
- L12 Swing Spout
- E3, 2.2 GPM Pressure Compensating Softflo® Aerator
- 204 Cross Handles with Hot and Cold Water Service Buttons
- Slow Compression Operating Cartridges
- 3/8" O.D. Copper Supply Tubes



BUY  
AMERICAN  
ACT  
COMPLIANT

### 931-VBE3-2CP

- Combination Hot and Cold Water Fitting
- L8BVB Atmospheric Vacuum Breaker Swing Spout\*
- E3-2, 2.2 GPM Pressure Compensating Softflo® Aerator
- 204 Cross Handles with Hot and Cold Water Service Buttons
- Slow Compression Operating Cartridges
- 3/8" O.D. Copper Supply Tubes



BUY  
AMERICAN  
ACT  
COMPLIANT

### 931-VBE7CP

- Combination Hot and Cold Water Fitting
- L8BVB Atmospheric Vacuum Breaker Swing Spout\*
- E7 Removable Serrated Hose Nozzle
- 204 Cross Handles with Hot and Cold Water Service Buttons
- Slow Compression Operating Cartridges
- 3/8" O.D. Copper Supply Tubes



BUY  
AMERICAN  
ACT  
COMPLIANT

### 941-CP

- Combination Hot and Cold Water Fitting
- S6 Cast Swing Spout
- E3-2, 2.2 GPM Pressure Compensating Softflo® Aerator
- 204 Cross Handles with Hot and Cold Water Service Buttons
- Slow Compression Operating Cartridges
- "LS" 1/2" NPT Female Tall Angle Supply Arms
- 748-002K 1/2" NPT x NPSM Male Inlet Shank Assembly - Shipped Loose



BUY  
AMERICAN  
ACT  
COMPLIANT

### 941-VBE7CP

- Combination Hot and Cold Water Fitting
- L8BVB Atmospheric Vacuum Breaker Swing Spout\*
- E7 Removable Serrated Hose Nozzle
- 204 Cross Handles with Hot and Cold Water Service Buttons
- Slow Compression Operating Cartridges
- "LS" 1/2" NPT Female Tall Angle Supply Arms
- 748-002K 1/2" NPT x NPSM Male Inlet Shank Assembly - Shipped Loose



BUY  
AMERICAN  
ACT  
COMPLIANT

### 946-CP

- Combination Hot and Cold Water Fitting
- GN2B Rigid/Swing Gooseneck Spout
- E7 Removable Serrated Hose Nozzle
- 204 Cross Handles with Hot and Cold Water Service Buttons
- Slow Compression Operating Cartridges
- "SS" 1/2" NPT Female Short Angle Supply Arms
- 748-002K 1/2" NPT x NPSM Male Inlet Shank Assembly - Shipped Loose



BUY  
AMERICAN  
ACT  
COMPLIANT

### 947-317CP

- Combination Hot and Cold Water Fitting
- GN2BVB Rigid/Swing Atmospheric Vacuum Breaker Gooseneck Spout\*
- E7 Removable Serrated Hose Nozzle
- 317 Indexed Wristblade Handles
- Quatum™ Operating Cartridges
- "SS" 1/2" NPT Female Short Angle Supply Arms
- 748-002K 1/2" NPT x NPSM Male Inlet Shank Assembly - Shipped Loose



# WATER FITTINGS

## Deck Mounted



BUY  
AMERICAN  
ACT  
CONFIDENTIAL

### 947-369CP

- Combination Hot and Cold Water Fitting
- GN2BVB Rigid/Swing Atmospheric Vacuum Breaker Gooseneck Spout\*
- E7 Removable Serrated Hose Nozzle
- 369 Indexed Lever Handles
- Quatum™ Operating Cartridges
- "SS" 1/2" NPT Female Short Angle Supply Arms
- 748-002K 1/2" NPT x NPSM Male Inlet Shank Assembly - Shipped Loose



BUY  
AMERICAN  
ACT  
CONFIDENTIAL

### 947-CP

- Combination Hot and Cold Water Fitting
- GN2BVB Rigid/Swing Atmospheric Vacuum Breaker Gooseneck Spout\*
- E7 Removable Serrated Hose Nozzle
- 204 Cross Handles with Hot and Cold Water Service Buttons
- Slow Compression Operating Cartridges
- "SS" 1/2" NPT Female Short Angle Supply Arms
- 748-002K 1/2" NPT x NPSM Male Inlet Shank Assembly - Shipped Loose



BUY  
AMERICAN  
ACT  
CONFIDENTIAL

### 1334-CP

- Single Service One Piece Cast Brass Spout
- Gas Outlets Plugged
- E7 Removable Serrated Hose Nozzle
- 205 Plastic Cross Handle with Cold Water Service Button
- Slow Compression Operating Cartridge
- (2) 3/8" NPT Male Inlet Shank Assemblies

## Wall Mounted



BUY  
AMERICAN  
ACT  
CONFIDENTIAL

### 932-VBE7WSCP

- Single Inlet Water Fitting
- L8BVB Atmospheric Vacuum Breaker Swing Spout\*
- E7 Removable Serrated Hose Nozzle
- 204 Cross Handle with Cold Water Service Button
- Slow Compression Operating Cartridge
- 1/2" NPT Inlet Shank Assembled



BUY  
AMERICAN  
ACT  
CONFIDENTIAL

### 932-WSCP

- Single Inlet Water Fitting
- S6 Cast Swing Spout
- E3, 2.2 GPM Pressure Compensating Softflo® Aerator
- 204 Cross Handle with Cold Water Service Button
- Slow Compression Operating Cartridge
- 1/2" NPT Inlet Shank Assembled



BUY  
AMERICAN  
ACT  
CONFIDENTIAL

### 933-CP

- Single Inlet Water Fitting
- GN2B Rigid/Swing Gooseneck Spout
- E7 Removable Serrated Hose Nozzle
- 204 Cross Handle with Cold Water Service Button
- Slow Compression Operating Cartridge
- 1/2" NPT Flanged Female Inlet



BUY  
AMERICAN  
ACT  
CONFIDENTIAL

### 933-WSCP

- Single Inlet Water Fitting
- GN2B Rigid/Swing Gooseneck Spout
- E7 Removable Serrated Hose Nozzle
- 204 Cross Handle with Cold Water Service Button
- Slow Compression Operating Cartridge
- 1/2" NPT Inlet Shank Assembled



BUY  
AMERICAN  
ACT  
CONFIDENTIAL

### 934-CP

- Single Inlet Water Fitting
- GN2BVB Rigid/Swing Atmospheric Vacuum Breaker Gooseneck Spout\*
- E7 Removable Serrated Hose Nozzle
- 204 Cross Handle with Cold Water Service Button
- Slow Compression Operating Cartridge
- 1/2" NPT Flanged Female Inlet



BUY  
AMERICAN  
ACT  
CONFIDENTIAL

### 934-WSCP

- Single Inlet Water Fitting
- GN2BVB Rigid/Swing Atmospheric Vacuum Breaker Gooseneck Spout\*
- E7 Removable Serrated Hose Nozzle
- 204 Cross Handle with Cold Water Service Button
- Slow Compression Operating Cartridge
- 1/2" NPT Inlet Shank Assembled

## Wall Mounted



BUY  
AMERICAN  
ACT  
COMPLIANT

### 938-CP

- Single Inlet Water Fitting
- E7 Removable Serrated Hose Nozzle
- 204 Cross Handle with Cold Water Service Button
- Slow Compression Operating Cartridge
- 1/2" NPT Female Inlet



BUY  
AMERICAN  
ACT  
COMPLIANT

### 938-WSCP

- Single Inlet Water Fitting
- E7 Removable Serrated Hose Nozzle
- 204 Cross Handle with Cold Water Service Button
- Slow Compression Operating Cartridge
- 1/2" NPT Inlet Shank Assembled



BUY  
AMERICAN  
ACT  
COMPLIANT

### 940-CP

- Combination Hot and Cold Water Fitting
- S6 Cast Swing Spout
- E3, 2.2 GPM Pressure Compensating Softflo® Aerator
- 204 Cross Handles with Hot and Cold Water Service Buttons
- Slow Compression Operating Cartridges
- "G" Adjustable 1/2" NPT Female Supply Arms
- 1/2" NPT Male Inlet Shank Assemblies
- Shipped Loose



BUY  
AMERICAN  
ACT  
COMPLIANT

### 940-VBE7WSLCP

- Combination Hot and Cold Water Fitting
- L8BVB Atmospheric Vacuum Breaker Swing Spout\*
- E7 Removable Serrated Hose Nozzle
- 204 Cross Handles with Hot and Cold Water Service Buttons
- Slow Compression Operating Cartridges
- "G" Adjustable 1/2" NPT Female Supply Arms
- 1/2" NPT Male Inlet Shank Assemblies
- Shipped Loose



BUY  
AMERICAN  
ACT  
COMPLIANT

### 940-WSLCP

- Combination Hot and Cold Water Fitting
- S6 Cast Swing Spout
- E3, 2.2 GPM Pressure Compensating Softflo® Aerator
- 204 Cross Handles with Hot and Cold Water Service Buttons
- Slow Compression Operating Cartridges
- "G" Adjustable 1/2" NPT Female Supply Arms
- 1/2" NPT Male Inlet Shank Assemblies
- Shipped Loose



BUY  
AMERICAN  
ACT  
COMPLIANT

### 942-CP

- Combination Hot and Cold Water Fitting
- GN2B Rigid/Swing Gooseneck Spout
- E7 Removable Serrated Hose Nozzle
- 204 Cross Handles with Hot and Cold Water Service Buttons
- Slow Compression Operating Cartridges
- "G" Adjustable 1/2" NPT Female Supply Arms
- 1/2" NPT Male Inlet Shanks
- Required for Installation (Order Separately)



BUY  
AMERICAN  
ACT  
COMPLIANT

### 942-WSLCP

- Combination Hot and Cold Water Fitting
- GN2B Rigid/Swing Gooseneck Spout
- E7 Removable Serrated Hose Nozzle
- 204 Cross Handles with Hot and Cold Water Service Buttons
- Slow Compression Operating Cartridges
- "G" Adjustable 1/2" NPT Female Supply Arms
- 1/2" NPT Male Inlet Shank Assemblies
- Shipped Loose



BUY  
AMERICAN  
ACT  
COMPLIANT

### 943-317CP

- Combination Hot and Cold Water Fitting
- GN2BVB Rigid/Swing Atmospheric Vacuum Breaker Gooseneck Spout\*
- E7 Removable Serrated Hose Nozzle
- 317 Indexed Wristblade Handles
- Quatum™ Operating Cartridges
- "G" Adjustable 1/2" NPT Female Supply Arms
- 1/2" NPT Male Inlet Shanks
- Required for Installation (Order Separately)



BUY  
AMERICAN  
ACT  
COMPLIANT

### 943-CP

- Combination Hot and Cold Water Fitting
- GN2BVB Rigid/Swing Atmospheric Vacuum Breaker Gooseneck Spout\*
- E7 Removable Serrated Hose Nozzle
- 204 Cross Handles with Hot and Cold Water Service Buttons
- Slow Compression Operating Cartridges
- "G" Adjustable 1/2" NPT Female Supply Arms
- 1/2" NPT Male Inlet Shanks
- Required for Installation (Order Separately)

# WATER FITTINGS



## Wall Mounted



BUY  
AMERICAN  
ACT  
COMPLIANT

### 943-WSLCP

- Combination Hot and Cold Water Fitting
- GN2BVB Rigid/Swing Atmospheric Vacuum Breaker Gooseneck Spout\*
- E7 Removable Serrated Hose Nozzle
- 204 Cross Handles with Hot and Cold Water Service Buttons
- Slow Compression Operating Cartridges
- "G" Adjustable 1/2" NPT Female Supply Arms
- 1/2" NPT Male Inlet Shank Assemblies
- Shipped Loose



BUY  
AMERICAN  
ACT  
COMPLIANT

### 1300-CP

- Single Inlet Water Fitting
- Atmospheric Vacuum Breaker\*
- E7XT 30° Angled Serrated Hose Nozzle
- 204 Cross Handle with Cold Water Service Button
- Slow Compression Operating Cartridge
- 1/2" NPT Flanged Female Inlet



BUY  
AMERICAN  
ACT  
COMPLIANT

### 1300-MCP

- Single Inlet Water Fitting
- Atmospheric Vacuum Breaker\*
- E7XT 30° Angled Serrated Hose Nozzle
- 204 Cross Handle with Cold Water Service Button
- Slow Compression Operating Cartridge
- 1/2" NPT Male Inlet

## Deck or Wall Mounted



BUY  
AMERICAN  
ACT  
COMPLIANT

### 1305-CP

- Concealed Water Valve
- 1/2" NPT Female Side Outlet
- 204 Cross Handle with Cold Water Service Button
- Slow Compression Operating Cartridge
- 1/2" NPSM Coupling Nut for 3/8" or 1/2" Flexible Riser



BUY  
AMERICAN  
ACT  
COMPLIANT

### 1305-PLCP

- Concealed Water Valve
- 1/2" NPT Female Side Outlet
- 204 Cross Handle with Plain Button
- Slow Compression Operating Cartridge
- 1/2" NPSM Coupling Nut for 3/8" or 1/2" Flexible Riser



BUY  
AMERICAN  
ACT  
COMPLIANT

### 828-ACP

- Deck Mounted Pure Water Fitting
- Polypropylene Valve Body Assembly
- PTFE Liner with Chrome Plated Brass Housing
- Removable Serrated Hose Nozzle
- 3-Arm Polypropylene Handle
- Polypropylene Cartridge with PTFE Seat
- 3/8" NPT Polypropylene Male Inlet



BUY  
AMERICAN  
ACT  
COMPLIANT

### 829-ACP

- Wall Mounted Pure Water Fitting
- Polypropylene Valve Body Assembly
- PTFE Liner with Chrome Plated Brass Housing
- Removable Serrated Hose Nozzle
- 3-Arm Polypropylene Handle
- Polypropylene Cartridge with PTFE Seat
- 3/8" NPT Polypropylene Male Inlet



BUY  
AMERICAN  
ACT  
COMPLIANT

### 838-CP

- Deck Mounted Pure Water Fitting
- Chrome Plated Spout with Tygon® Lining
- Integral Serrated Hose Nozzle
- Self Closing Push/Pull to Lock Handle Open
- Celcon® Valve
- 1/2" NPT Male Inlet



BUY  
AMERICAN  
ACT  
COMPLIANT

### 839-CP

- Wall Mounted Pure Water Fitting
- Chrome Plated Spout with Tygon® Lining
- Integral Serrated Hose Nozzle
- Self Closing Push/Pull to Lock Handle Open
- Celcon® Valve
- 1/2" NPT Male Inlet

# WATER FITTINGS



a Geberit company

## Pure Water Fittings



### 869-BLHPVC

- Deck Mounted PVC Distilled Water Fitting Left Hand Operation
- PVC Rigid Gooseneck Spout
- Integral Serrated Hose Nozzle
- 3-Arm PVC Handle
- PVC Valve
- 3/8" NPT Female Inlet or 1/2" NPSM Male Inlet



### 869-BPVC

- Deck Mounted PVC Distilled Water Fitting
- PVC Rigid Gooseneck Spout
- Integral Serrated Hose Nozzle
- 3-Arm PVC Handle
- PVC Valve
- 3/8" NPT Female Inlet or 1/2" NPSM Male Inlet



### 870-BPVC

- Wall Mounted PVC Distilled Water Fitting
- PVC Rigid Gooseneck Spout
- Integral Serrated Hose Nozzle
- 3-Arm PVC Handle
- PVC Valve
- 3/8" NPT Female Inlet or 1/2" NPSM Male Inlet



### 969-217XLHCTF

- Deck Mounted Distilled Water Fitting
- All Internal Surfaces Are Tin Lined
- GN2B Rigid/Swing Gooseneck Spout
- E7 Removable Serrated Hose Nozzle
- 204 Cross Handle with DW Service Button
- Slow Compression Cartridge
- 1/4" NPT Male Inlet Tailpiece



### 969-CTF

- Deck Mounted Distilled Water Fitting
- All Internal Surfaces Are Tin Lined
- GN2B Rigid/Swing Gooseneck Spout
- E7 Removable Serrated Hose Nozzle
- 204 Cross Handle with DW Service Button
- Self-Closing Cartridge
- 1/4" NPT Male Inlet Tailpiece



### 970-CTF

- Wall Mounted Distilled Water Fitting
- All Internal Surfaces Are Tin Lined
- GN2B Rigid/Swing Gooseneck Spout
- E7 Removable Serrated Hose Nozzle
- 204 Cross Handle with DW Service Button
- Self-Closing Cartridge
- 1/2" NPT Flanged Female Inlet



### 971-CTF

- Wall Mounted Distilled Water Fitting
- All Internal Surfaces Are Tin Lined
- E7 Removable Serrated Hose Nozzle
- 204 Cross Handle with DW Service Button
- Self-Closing Cartridge
- 3/8" NPT Male Inlet Thread



### 972-CTF

- Wall Mounted Distilled Water Fitting
- All Internal Surfaces Are Tin Lined
- E7 Removable Serrated Hose Nozzle
- 204 Cross Handle with DW Service Button
- Self-Closing Cartridge
- 1/2" NPT Flanged Female Inlet

# REMOTE CONTROLLED FITTINGS

## Panel Mounted



BUY  
AMERICAN  
ACT  
COMPLIANT

### 913-AGVCP

- Right-Hand 45° Angle Control Valve
- 204 Cross Handle with Air, Gas And Vacuum Service Buttons
- Needle Valve Cartridge
- 3/8" NPT Female Inlet and Outlet



BUY  
AMERICAN  
ACT  
COMPLIANT

### 914-CP

- Right-Hand 45° Angle Control Water Valve
- 204 Cross Handle with Cold Water Service Button
- Slow Compression Operating Cartridge
- 3/8" NPT Female Inlet and Outlet



BUY  
AMERICAN  
ACT  
COMPLIANT

### 915-CP

- Left-Hand 45° Angle Control Steam Valve
- 204 Cross Handle with Steam Service Button
- Slow Compression Operating Cartridge
- 3/8" NPT Female Inlet and Outlet

## Wall / Panel Mounted



BUY  
AMERICAN  
ACT  
COMPLIANT

### 962-VOACP

- Remote Control Water Valve for 45° Angle Panels
- Wall Flange and Extension Rod
- 204 Cross Handle with Cold Water Service Button
- Slow Compression Operating Cartridge
- 3/8" NPT Female Inlet and Outlet



BUY  
AMERICAN  
ACT  
COMPLIANT

### 962-VOCP

- Remote Control Water Valve for Straight Panels
- Wall Flange and Extension Rod
- 204 Cross Handle with Cold Water Service Button
- Slow Compression Operating Cartridge
- 3/8" NPT Female Inlet and Outlet



BUY  
AMERICAN  
ACT  
COMPLIANT

### 962-VOGAAGVCP

- Remote Control Needle Valve for 45° Angle Panels
- Wall Flange and Extension Rod
- 204 Cross Handle with Air, Gas and Vac Service Buttons
- Needle Valve Cartridge
- 3/8" NPT Female Inlet and Outlet



BUY  
AMERICAN  
ACT  
COMPLIANT

### 962-VOGAGVCP

- Remote Control Needle Valve for Straight Panels
- Wall Flange and Extension Rod
- 204 Cross Handle with Air, Gas and Vac Service Buttons
- Needle Valve Cartridge
- 3/8" NPT Female Inlet and Outlet



BUY  
AMERICAN  
ACT  
COMPLIANT

### 962-VOSCP

- Remote Control Steam Valve for Straight Panels
- Wall Flange and Extension Rod
- 204 Cross Handle with Steam Service Button
- Slow Compression Operating Cartridge
- 3/8" NPT Female Inlet and Outlet



BUY  
AMERICAN  
ACT  
COMPLIANT

### 986-E7TCP

- Wall Flange with Serrated Hose Nozzle
- E7T Removable Serrated Hose Nozzle
- 3/8" NPT Inlet Shank - Shipped Loose



# REMOTE CONTROLLED FITTINGS / TURRETS

**CHICAGO  
FAUCETS**

a Geberit company

## Wall / Panel Mounted



### 986-E7XTCP

- Wall Flange with Serrated Hose Nozzle
- E7XT 30° Removable Angled Serrated Hose Nozzle
- 3/8" NPT Inlet Shank - Shipped Loose



### 986-FE7XTCP

- Wall Flange with Serrated Hose Nozzle
- E7XT 30° Removable Angled Serrated Hose Nozzle
- 3/8" NPT Female Inlet Thread



### 988-WSGN2BVBE7CP

- Wall Flange with Spout
- GN2BVB Rigid/Swing Atmospheric Vacuum Breaker Gooseneck Spout\*
- E7 Removable Serrated Hose Nozzle
- 3/8" NPT Inlet Shank Assembled



### 1322-205AGVCP

- Concealed Valve
- 205 Plastic Cross Handle with Air, Gas and Vac Service Buttons
- Needle Valve Cartridge
- 3/8" NPT Female Inlet and Outlet



### 1322-AGVCP

- Concealed Valve
- 204 Cross Handle with Air, Gas and Vac Service Buttons
- Needle Valve Cartridge
- 3/8" NPT Female Inlet and Outlet



### 1323-CP

- Concealed Valve
- 204 Cross Handle with Plain Water Service Button
- Slow Compression Operating Cartridge
- 3/8" NPT Female Inlet and Outlet

## Deck Mounted



### 900-CP

- Single Service Fitting
- GN2B Rigid/Swing Gooseneck Spout
- E7 Removable Serrated Hose Nozzle
- 3/8" NPT Female Inlet



### 980-CP

- Turret with One Side Outlet
- 3/8" NPT Female Inlet and Outlet Thread
- 957-003K 3/8" NPT Inlet Shank
- Required for Installation (Order Separately)



### 980-VP CP

- Turret with One Side Outlet and Vandal Resistant Pin
- 3/8" NPT Female Inlet and Outlet Thread
- 957-003K 3/8" NPT Inlet Shank
- Required for Installation (Order Separately)

## Turrets

# TURRETS



## Turrets



BUY  
AMERICAN  
ACT  
COMPLIANT

### 980-WSCP

- Turret with One Side Outlet
- 3/8" NPT Female Outlet Thread
- 3/8" NPT Inlet Shank Assembled



BUY  
AMERICAN  
ACT  
COMPLIANT

### 980-WSE7TCP

- Turret with Serrated Hose Nozzle
- E7T Removable Serrated Hose Nozzle
- 3/8" NPT Inlet Shank Assembled



BUY  
AMERICAN  
ACT  
COMPLIANT

### 981-CP

- Turret with Two Side Outlets @ 180°
- (2) 3/8" NPT Female Outlets
- 957-003K 3/8" NPT Inlet Shank
- Required for Installation (Order Separately)



BUY  
AMERICAN  
ACT  
COMPLIANT

### 981-WSCP

- Turret with Two Side Outlets @ 180° and Inlet Shank
- (2) 3/8" NPT Female Outlets
- 3/8" NPT Inlet Shank Assembled



BUY  
AMERICAN  
ACT  
COMPLIANT

### 982-CP

- Turret with Two Side Outlets @ 90°
- (2) 3/8" NPT Female Outlets
- 957-003K 3/8" NPT Inlet Shank
- Required for Installation (Order Separately)



BUY  
AMERICAN  
ACT  
COMPLIANT

### 982-VPCT

- Turret with Two Side Outlets @ 90° and Vandal Resistant Pin
- (2) 3/8" NPT Female Outlets
- 957-003K 3/8" NPT Inlet Shank
- Required for Installation (Order Separately)



BUY  
AMERICAN  
ACT  
COMPLIANT

### 982-WSCP

- Turret with Two Side Outlets @ 90°
- (2) 3/8" NPT Female Outlets
- 3/8" NPT Inlet Shank Assembled



BUY  
AMERICAN  
ACT  
COMPLIANT

### 983-WSCP

- Turret with Three Side Outlets @ 90°
- (3) 3/8" NPT Female Outlets
- 3/8" NPT Inlet Shank Assembled



BUY  
AMERICAN  
ACT  
COMPLIANT

### 984-CP

- Turret with Four Side Outlets @ 90°
- (4) 3/8" NPT Female Outlets
- 957-003K 3/8" NPT Inlet Shank
- Required for Installation (Order Separately)

## Turrets



### 984-WSCP

- Turret with Four Side Outlets @ 90°
- (4) 3/8" NPT Female Outlets
- 3/8" NPT Inlet Shank Assembled

## Combo Valve & Turret



### 980-909-957-3KAGVCP

- Turret with Single Ball Valve
- E7T Removable Serrated Hose Nozzle
- Lever Handle with Air, Gas and Vac Service Buttons
- 3/8" NPT Inlet Shank - Shipped Loose



### 980-909AGVCP

- Turret with Single Ball Valve
- E7T Removable Serrated Hose Nozzle
- Lever Handle with Air, Gas and Vac Service Buttons
- 957-003K 3/8" NPT Inlet Shank
- Required for Installation (Order Separately)



### 980-909CAGCP

- Turret with Single Ball Valve
- E7TC Removable Serrated Hose Nozzle with Check
- Lever Handle with Air and Gas Service Buttons
- 957-003K 3/8" NPT Inlet Shank
- Required for Installation (Order Separately)



### 980-937CHAGVCP

- Turret with Single Needle Valve
- E7 Removable Serrated Hose Nozzle
- 204 Cross Handle with Air, Gas and Vac Service Buttons
- Needle Valve Cartridge
- 957-003K 3/8" NPT Inlet Shank
- Required for Installation (Order Separately)



### 980-VR909CAGCP

- Vandal Resistant Turret with Single Ball Valve
- E7TC Serrated Hose Nozzle with Check
- Lever Handle with Air and Gas Service Buttons
- Vandal Resistant Pin in Turret
- All Threaded Connections Cemented
- 3/8" NPT Inlet Shank Assembled



### 980-WS909AGVCP

- Turret with Single Ball Valve
- E7T Removable Serrated Hose Nozzle
- Lever Handle with Air, Gas and Vac Service Buttons
- 3/8" NPT Inlet Shank Assembled



### 980-WS909CAGCP

- Turret with Single Ball Valve
- E7TC Removable Serrated Hose Nozzle with Check
- Lever Handle with Air and Gas Service Buttons
- 3/8" NPT Inlet Shank Assembled



### 981-901B957-3KAGVCP

- Turret with Two Needle Valves @ 180°
- Integral Serrated Hose Nozzle
- 945 Wheel Handles with Air, Gas and Vac Service Buttons
- Needle Valve Cartridges
- 3/8" NPT Inlet Shank - Shipped Loose

# TURRETS

## Combo Valve & Turret



### 981-909-957-3KAGVCP

- Turret with Two Ball Valves @ 180°
- E7T Removable Serrated Hose Nozzle
- Lever Handles with Air, Gas and Vac Service Buttons
- 3/8" NPT Inlet Shank - Shipped Loose



### 981-909AGVCP

- Turret with Two Ball Valves @ 180°
- E7T Removable Serrated Hose Nozzle
- Lever Handles with Air, Gas and Vac Service Buttons
- 957-003K 3/8" NPT Inlet Shank  
- Required for Installation (Order Separately)



### 981-909CAGCP

- Turret with Two Ball Valves @ 180°
- E7TC Removable Serrated Hose Nozzle with Check
- Lever Handles with Air, Gas and Vac Service Buttons
- 957-003K 3/8" NPT Inlet Shank  
- Required for Installation (Order Separately)



### 981-937CHAGVCP

- Turret with Two Needle Valves @ 180°
- E7 Removable Serrated Hose Nozzle
- 204 Cross Handles with Air, Gas and Vac Service Buttons
- Needle Valve Cartridges
- 957-003K 3/8" NPT Inlet Shank  
- Required for Installation (Order Separately)



### 981-VR909AGVCP

- Vandal Resistant Turret with Two Ball Valves @ 180°
- E7T Serrated Hose Nozzle
- Lever Handles with Air, Gas and Vac Service Buttons
- Vandal Resistant Pin in Turret
- All Threaded Connections Cemented
- 3/8" NPT Inlet Shank Assembled



### 981-VR909CAGCP

- Vandal Resistant Turret with Two Ball Valves @ 180°
- E7TC Serrated Hose Nozzle with Check
- Lever Handles with Air and Gas Service Buttons
- Vandal Resistant Pin in Turret
- All Threaded Connections Cemented
- 3/8" NPT Inlet Shank Assembled



### 981-WS909AGVCP

- Turret with Two Ball Valves @ 180°
- E7T Removable Serrated Hose Nozzle with Check Valve
- Lever Handles with Air, Gas and Vac Service Buttons
- 3/8" NPT Inlet Shank Assembled



### 981-WS909CAGCP

- Turret with Two Ball Valves @ 180°
- E7TC Removable Serrated Hose Nozzle with Check
- Lever Handles with Air and Gas Service Buttons
- 3/8" NPT Inlet Shank Assembled



### 981-WS937CHAGVCP

- Turret with Two Needle Valves @ 180°
- E7 Removable Serrated Hose Nozzles
- 204 Cross Handles with Air, Gas and Vac Service Buttons
- Needle Valve Cartridges
- 3/8" NPT Inlet Shank Assembled

## Combo Valve & Turret



### 982-909-957-3KAGVCP

- Turret with Two Ball Valves @ 90°
- E7T Removable Serrated Hose Nozzle
- Lever Handles with Air, Gas and Vac Service Buttons
- 3/8" NPT Inlet Shank - Shipped Loose



### 982-909AGVCP

- Turret with Two Ball Valves @ 90°
- E7T Removable Serrated Hose Nozzle
- Lever Handles with Air, Gas and Vac Service Buttons
- 957-003K 3/8" NPT Inlet Shank
- Required for Installation (Order Separately)



### 982-909CAGCP

- Turret with Two Ball Valves @ 90°
- E7TC Removable Serrated Hose Nozzle with Check
- Lever Handles with Air and Gas Service Buttons
- 957-003K 3/8" NPT Inlet Shank
- Required for Installation (Order Separately)



### 982-937CHAGVCP

- Turret with Two Needle Valves @ 90°
- E7 Removable Serrated Hose Nozzle
- 204 Cross Handles with Air, Gas and Vac Service Buttons
- Needle Valve Cartridges
- 957-003K 3/8" NPT Inlet Shank
- Required for Installation (Order Separately)



### 982-DS909AGVCP

- Dual Service Turret with Two Ball Valves @ 90°
- E7T Removable Serrated Hose Nozzle
- Lever Handles with Air, Gas and Vac Service Buttons
- (2) 3/8" NPT Inlet Shanks - Shipped Loose



### 982-DSVR909CAGCP

- Vandal Resistant Dual Service Turret with Two Ball Valves @ 90°
- E7TC Removable Serrated Hose Nozzle with Check
- Lever Handles with Air and Gas Service Buttons
- Vandal Resistant Pin in Turret
- All Threaded Connections Cemented
- (2) 3/8" NPT Inlet Shanks Assembled



### 982-VP909CAGCP

- Turret with Two Ball Valves @ 90° and Vandal Resistant Pin
- E7TC Removable Serrated Hose Nozzles with Check
- Lever Handles with Air and Gas Service Buttons
- Vandal Resistant Pin in Turret
- 957-003K 3/8" NPT Inlet Shank
- Required for Installation (Order Separately)



### 982-VR909AGVCP

- Vandal Resistant Turret with Two Ball Valves @ 90°
- E7T Serrated Hose Nozzles
- Lever Handles with Air, Gas and Vac Service Buttons
- Vandal Resistant Pin in Turret
- All Threaded Connections Cemented
- 3/8" NPT Inlet Shank Assembled



### 982-VR909CAGCP

- Vandal Resistant Turret with Two Ball Valves @ 90°
- E7TC Serrated Hose Nozzles with Check
- Lever Handles with Air and Gas Service Buttons
- Vandal Resistant Pin in Turret
- All Threaded Connections Cemented
- 3/8" NPT Inlet Shank Assembled



# TURRETS

## Combo Valve & Turret



### 982-WS909AGVCP

- Turret with Two Ball Valves @ 90°
- E7T Removable Serrated Hose Nozzle
- Lever Handles with Air, Gas and Vac Service Buttons
- 3/8" NPT Inlet Shank Assembled



### 982-WS909CAGCP

- Turret with Two Ball Valves @ 90°
- E7TC Removable Serrated Hose with Check
- Lever Handles with Air and Gas Service Buttons
- 3/8" NPT Inlet Shank Assembled



### 983-909AGVCP

- Turret with Three Ball Valves @ 90°
- E7T Removable Serrated Hose Nozzle
- Lever Handles with Air, Gas and Vac Service Buttons
- 957-003K 3/8" NPT Inlet Shank
- Required for Installation (Order Separately)



### 984-VR909CAGCP

- Vandal Resistant Turret with Four Ball Valves @ 90°
- E7TC Serrated Hose with Check
- Lever Handles with Air and Gas Service Buttons
- Vandal Resistant Pin in Turret
- All Threaded Connections Cemented
- 3/8" NPT Inlet Shank Assembled



### 997-CP

- Three Water Valves
- GN2B Rigid/Swing Gooseneck Spout
- E7 Removable Serrated Hose Nozzles
- 204 Cross Handles with Cold Water Service Buttons
- Slow Compression Operating Cartridges
- 3/8" NPT Inlet Shank Assembled



### 980-WSGN2BVBE7CP

- Turret with Spout
- GN2BVB Rigid/Swing Atmospheric Vacuum Breaker Gooseneck Spout\*
- E7 Removable Serrated Hose Nozzle
- 3/8" NPT Inlet Shank Assembled



### 985-AWSGN2BVBE7CP

- Turret with Spout
- GN2BVB Rigid/Swing Atmospheric Vacuum Breaker Gooseneck Spout\*
- E7 Removable Serrated Hose Nozzle
- 3/8" NPT Inlet Shank Assembled



### 985-BCP

- Turret with Spout and Water Valve
- GN2B Rigid/Swing Gooseneck Spout
- E7 Removable Serrated Hose Nozzle
- 204 Cross Handle with Cold Water Service Button
- Slow Compression Operating Cartridge
- 3/8" NPT Inlet Shank - Shipped Loose



### 985-HRCP

- Turret with Spout
- 18" Elevated High Rise Spout Assembly
- L12 Swing Spout
- E3, 2.2 GPM Pressure Compensating Softflo® Aerator
- 3/8" NPT Inlet Shank Assembled

# VALVES & FLANGES



a Geberit company

## VALVES & FLANGES

## Needle Valve



BUY  
AMERICAN  
ACT  
COMPLIANT

### 937-CHAGVCP

- Single Service Fitting
- E7 Removable Serrated Hose Nozzle
- 204 Cross Handle with Air, Gas and Vac Service Buttons
- Needle Valve Cartridge
- 3/8" NPT Male Inlet
- May Be Used with Most Laboratory Gases



BUY  
AMERICAN  
ACT  
COMPLIANT

### 937-WHAGVCP

- Single Service Fitting
- E7 Removable Serrated Hose Nozzle
- 945 Wheel Handle with Air, Gas and Vac Service Buttons
- Needle Valve Cartridge
- 3/8" NPT Male Inlet
- May Be Used with Most Laboratory Gases



BUY  
AMERICAN  
ACT  
COMPLIANT

### 901-BAGVCP

- Single Service Fitting
- Integral Serrated Hose Nozzle
- 945 Wheel Handle with Air, Gas and Vac Service Buttons
- Needle Valve
- 3/8" NPT Male Inlet

## Ball Valve



BUY  
AMERICAN  
ACT  
COMPLIANT

### 954-CHAGVCP

- Angle Valve
- E7T Removable Serrated Hose Nozzle
- 204 Cross Handle with Air, Gas and Vac Service Buttons
- Needle Valve Cartridge
- 3/8" NPT Female Inlet



BUY  
AMERICAN  
ACT  
COMPLIANT

### 954-CP

- Angle Valve
- E7T Removable Serrated Hose Nozzle
- 204 Cross Handle with Cold Water Service Button
- Slow Compression Operating Cartridge
- 3/8" NPT Female Inlet



BUY  
AMERICAN  
ACT  
COMPLIANT



### 909-AGVCP

- Ball Valve
- E7T Removable Serrated Hose Nozzle
- Lever Handle with Air, Gas and Vac Service Buttons
- 3/8" NPT Male Inlet
- May Be Used with Most Laboratory Gases



BUY  
AMERICAN  
ACT  
COMPLIANT



### 909-AIRC

- Ball Valve
- E7T Removable Serrated Hose Nozzle
- Lever Handle with Air Index Button
- 3/8" NPT Male Inlet



BUY  
AMERICAN  
ACT  
COMPLIANT



### 909-CAGC

- Ball Valve
- E7TC Removable Serrated Hose Nozzle with Check
- Lever Handle with Air and Gas Button
- 3/8" NPT Male Inlet
- May Be Used with Most Laboratory Gases



BUY  
AMERICAN  
ACT  
COMPLIANT



### 909-CGASC

- Ball Valve
- E7TC Removable Serrated Hose Nozzle with Check
- Lever Handle with Gas Index Button
- 3/8" NPT Male Inlet
- May Be Used with Most Laboratory Gases

# VALVES & FLANGES



## Ball Valve

## Water Valve



### 909-GASCP

- Ball Valve
- E7T Removable Serrated Hose Nozzle
- Lever Handle with Gas Index Button
- 3/8" NPT Male Inlet
- May Be Used with Most Laboratory Gases



### 909-VACCP

- Ball Valve
- E7T Removable Serrated Hose Nozzle
- Lever Handle with Vac Service Button
- 3/8" NPT Male Inlet



### 937-CP

- Single Water Fitting
- E7 Removable Serrated Hose Nozzle
- 204 Cross Handle with Cold Water Service Button
- Slow Compression Operating Cartridge
- 3/8" NPT Male Inlet

## Flanges



### 937-STCP

- Single Water Fitting
- E7XT 30° Angled Removable Serrated Hose Nozzle
- 205 Plastic Cross Handle with Steam Service Button
- Slow Compression Steam Operating Cartridge
- 3/8" NPT Male Inlet

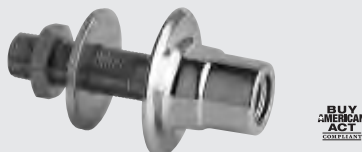

### 986-CP

- Wall Flange
- 3/8" NPT Female Outlet
- 3/8" NPT Inlet Shank - Shipped Loose



### 986-FCP

- Wall Flange
- 3/8" NPT Female Outlet
- 3/8" NPT Female Inlet

## Flange & Outlet



### 987-CP

- "Y" Pattern Wall Flange with Two Outlets @ 90°
- Two 3/8" NPT Female Outlets
- 3/8" NPT Inlet Shank - Shipped Loose



### 987-FCP

- "Y" Pattern Wall Flange with Two Outlets @ 90°
- Two 3/8" NPT Female Outlets
- 3/8" NPT Female Inlet



### 988-LWSCP

- 3 5/8" Horizontal Extended Wall Flange
- E7T Removable Serrated Hose Nozzle
- 3/8" NPT Inlet Shank Assembled (Not Shown)

## Flange & Outlet



BUY  
AMERICAN  
ACT  
COMPLIANT

### 988-WSCP

- Wall Flange with Serrated Hose Nozzle
- E7 Removable Serrated Hose Nozzle
- 3/8" NPT Inlet Shank Assembled (Not Shown)

## Combo Valve & Flange



BUY  
AMERICAN  
ACT  
COMPLIANT

### 986-909AGVCP

- Wall Flange with Ball Valve
- E7T Removable Serrated Hose Nozzle
- Lever Handle with Air, Gas and Vac Service Buttons
- 3/8" NPT Inlet Shank - Shipped Loose



BUY  
AMERICAN  
ACT  
COMPLIANT

### 986-937CHAGVCP

- Wall Flange with Needle Valve
- E7 Removable Serrated Hose Nozzle
- 204 Cross Handle with Air, Gas and Vac Service Buttons
- Needle Valve Cartridge
- 3/8" NPT Inlet Shank - Shipped Loose

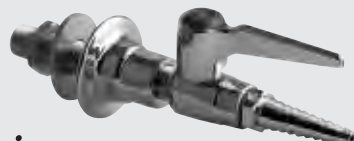

BUY  
AMERICAN  
ACT  
COMPLIANT

### 986-WSV909AGVCP

- Wall Flange with Ball Valve
- E7T Removable Serrated Hose Nozzle
- Lever Handle with Air, Gas and Vac Service Buttons
- 3/8" NPT Inlet Shank Assembled



BUY  
AMERICAN  
ACT  
COMPLIANT

### 986-WSV937CHAGVCP

- Wall Flange with Needle Valve
- E7 Removable Serrated Hose Nozzle
- 204 Cross Handle with Air, Gas and Vac Service Buttons
- Needle Valve Cartridge
- 3/8" NPT Inlet Shank Assembled



BUY  
AMERICAN  
ACT  
COMPLIANT

### 987-909AGVCP

- "Y" Pattern Wall Flange with Two Ball Valves @ 90°
- E7T Removable Angled Serrated Hose Nozzle
- Lever Handles with Air, Gas and Vac Service Buttons
- 3/8" NPT Inlet Shank - Shipped Loose

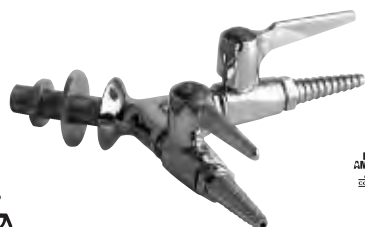

BUY  
AMERICAN  
ACT  
COMPLIANT

### 987-909CAGCP

- "Y" Pattern Wall Flange with Two Ball Valves @ 90°
- E7TC Removable Serrated Hose Nozzle with Check
- Lever Handles with Air and Gas Service Buttons
- 3/8" NPT Inlet Shank - Shipped Loose



BUY  
AMERICAN  
ACT  
COMPLIANT

### 987-937CHAGVCP

- "Y" Pattern Wall Flange with Two Needle Valves @ 90°
- E7 Removable Angled Serrated Hose Nozzle
- 204 Cross Handles with Air, Gas and Vac Service Buttons
- Needle Valve Cartridges
- 3/8" NPT Inlet Shank - Shipped Loose

# ACCESSORIES

## ACCESSORIES - Electrical Pedestal Assemblies



BUY  
AMERICAN  
ACT  
COMPANY

### 1310-ABAF

- Electrical Outlet Box
- Single Gang - Single Face
- For 120 Volt Service
- Grounding Screw
- Brushed Aluminum Finish
- 3/4" NPSM Mounting Shank Assembly
- UL Listed



BUY  
AMERICAN  
ACT  
COMPANY

### 1311-ABAF

- Electrical Outlet Box
- Single Gang - Double Face
- For 120 Volt Service
- Grounding Screw
- Brushed Aluminum Finish
- 3/4" NPSM Mounting Shank Assembly
- UL Listed



BUY  
AMERICAN  
ACT  
COMPANY

### 1312-ABAF

- Electrical Outlet Box
- Double Gang - Single Face
- For 120 Volt Service
- Grounding Screw
- Brushed Aluminum Finish
- 3/4" NPSM Mounting Shank Assembly
- UL Listed

## Aluminum Apparatus Fittings



BUY  
AMERICAN  
ACT  
COMPANY

### 1313-ABAF

- Electrical Outlet Box
- Double Gang - Double Face
- For 120 Volt Service
- Grounding Screw
- Brushed Aluminum Finish
- 3/4" NPSM Mounting Shank Assembly
- UL Listed



### 9901-NF

- Aluminum Burette Rod Socket 3/4"
- Recessed Mount



### 9902-NF

- Aluminum Upright Rod 3/4" x 36"



### 9903-NF

- Aluminum Crossbar Rod 3/4" x 36"

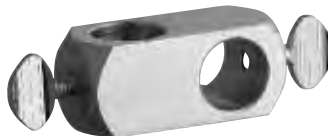

### 9904-NF

- Aluminum Adjustable Clamp 3/4"



### 9905-NF

- Aluminum Crossbar Rod 3/4" x 39"



## *Aluminum Apparatus Fittings*



### **9906-NF**

- Aluminum Crossbar Rod 3/4" x 24"



### **9907-NF**

- Aluminum Crossbar Rod 3/4" x 48"



### **9911-NF**

- Aluminum Upright Rod 3/4" x 24"



### **9912-NF**

- Aluminum Upright Rod 3/4" x 48"



### **9913-NF**

- Aluminum Burette Rod Socket 3/4"
- Countertop Mount

# SAFETY



## Emergency Shower

## Eye/Face Wash

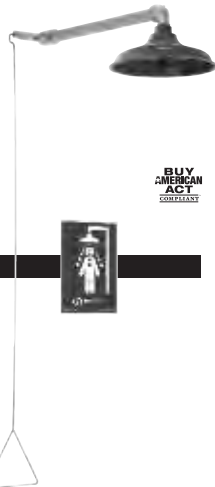

### 8100-NF

- Horizontal or Vertical Safety Drench Shower
- 9100-002 - 10" ABS Plastic Shower Head
- Stainless Steel Pull Rod
- 1" Ball Valve
- 1" Galvanized Piping
- 1" NPT Female Inlet

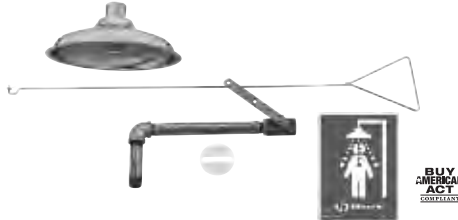

### 8101-NF

- Concealed Safety Drench Shower
- Stainless Steel Pull Rod
- 1" Ball Valve
- 1" Galvanized Piping
- 1" NPT Female Inlet



### 8001-NF

- Wall Mounted Eye/Face Wash
- Dual High Impact ABS Plastic Feather-Flo Spray Heads with Covers
- 90° Push Paddle Handle
- 11 1/4" Diameter Stainless Steel Receptacle
- 1 1/4" NPS Male Waste Outlet
- 1/2" NPT Female Inlet



### 8003-NF

- Floor Mounted Pedestal Eye/Face Wash
- Dual High Impact ABS Plastic Feather-Flo Spray Heads with Covers
- 90° Push Paddle Handle
- 10" Diameter Stainless Steel Receptacle
- 1 1/4" NPS Male Waste Outlet
- 1/2" NPT Female Inlet



### 8004-LHNF

- Left Hand Deck Mounted Swing Forward Eye/Face Wash
- Dual High Impact ABS Plastic Feather-Flo Spray Heads with Covers
- 90° Push Paddle Handle
- Valve is Fully Open when Rotated 90°
- 1/2" NPT Female Inlet



### 8004-RHNF

- Right Hand Deck Mounted Swing Forward Eye/Face Wash
- Dual High Impact ABS Plastic Soft-Flo Spray Heads with Covers
- 90° Push Paddle Handle
- Valve is Fully Open when Rotated 90°
- 1/2" NPT Female Inlet



### 8008-NF

- Recessed Wall Mounted Pull Down Eye/Face Wash
- Dual High Impact ABS Plastic Feather-Flo Spray Heads with Covers
- 90° Push Paddle Handle
- 1/2" NPT Female Inlet



### 8010-NF

- Deck Mounted Swing Down Eye/Face Wash
- Dual High Impact ABS Plastic Feather-Flo Spray Heads with Covers
- Valve is Fully Open in Horizontal Position
- 1/2" O. D. Female Inlet



### 8011-NF

- Deck Mounted Swing Forward Eye/Face Wash
- Dual High Impact ABS Plastic Feather-Flo Spray Heads with Covers
- Valve is Fully Open when Rotated 90°
- 1/2" O. D. Female Inlet



## Combo Shower - Eye/Face Wash



### 8202-NF

- Combination Omni-Flo Eye/Face Wash and Safety Drench Shower
- 9100-002 - 10" ABS Plastic Shower Head
- Dual High Impact ABS Plastic Feather-Flo Spray Heads with Covers
- Stainless Steel Pull Rod
- 90° Push Paddle Handle
- 94" Maximum Overall Height
- Stainless Steel Eye Wash Receptor



### 8205-NF

- Wheel Chair Accessible Combination Eye/Face Wash and Safety Drench Shower
- 9100-002 - 10" ABS Plastic Shower Head
- Dual High Impact ABS Plastic Feather-Flo Spray Heads with Covers
- Stainless Steel Pull Rod
- 90" Maximum Overall Height
- Stainless Steel Eye Wash Receptor



### 8206-NF

- Combination Omni-Flo Eye/Face Wash and Safety Drench Shower
- 9100-002 - 10" ABS Plastic Shower Head
- Dual High Impact ABS Plastic Feather-Flo Spray Heads with Covers
- Stainless Steel Pull Rod
- 94" Maximum Overall Height
- ABS Plastic Eye Wash Receptor

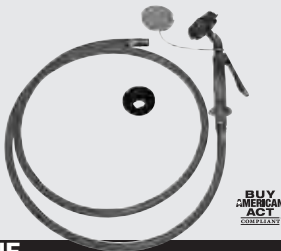

### 8305-NF

- Deck Mounted Dual Outlet Eye/Face/Body Drench Hose
- High Impact ABS Plastic Feather-Flo Spray Heads with Covers
- Stay Open Squeeze Handle
- 8' Rubber Hose
- 1/2" NPT Male Inlet



### 8310-NF

- Wall Mounted Dual Outlet Eye/Face/Body Drench Hose
- Dual High Impact ABS Plastic Feather-Flo Spray Heads with Covers
- Stay Open Squeeze Handle
- 12' Coiled Rubber Hose
- 1/2" NPT Male Inlet with Wall Flange

## Accessories



### 9400-NF

- Continuous Pressure Vacuum Breaker
- 1/2" NPT Female Outlet
- 1/2" NPT Male Inlet

# WARRANTY

## *Limited Warranty*

### **TO WHOM DOES THIS WARRANTY APPLY?**

The Company extends the following limited warranty to the original user only.

### **WHAT DOES THIS WARRANTY COVER AND HOW LONG DOES IT LAST?**

This warranty covers the following Commercial Products:

#### **LIFETIME FAUCET WARRANTY**

The “Faucet”, defined as any metal cast, forged, stamped, or formed portion of the Product, not including electronic or moving parts or other products separately covered by this Limited Warranty or water restricting components or other components, is warranted against material manufacturing defects for the life of the Product.

#### **FIVE YEAR FAUCET WARRANTY**

Certain Products and portions of the Product are warranted against material manufacturing defects for a period of five (5) years from the date of Product purchase. Products warranted against material manufacturing defects for a period of five (5) years from the date of Product purchase are referred to by the product numbers 42X, 43X, 15XX, and E-Tronic® - 4X, 5X, 6X, 7X, 8X, and 9X. All zinc die cast portions of Product are warranted against material manufacturing defects for a period of five (5) years from the date of Product purchase.

#### **FIVE YEAR CARTRIDGE WARRANTY**

The “Cartridge”, defined as the metal portion of any Product typically referred to by the product numbers containing 1-099, 1-100, 1-310, 377X, 217X, and 274X, excluding any rubber or plastic components, is warranted against material manufacturing defects for a period of five (5) years from the date of Product purchase. All Cartridges included in the Company's Single Control or Shower Products also are warranted against material manufacturing defects for a period of five (5) years from the date of Product purchase.

#### **ONE YEAR FINISH WARRANTY – COMMERCIAL**

For Products used in commercial applications, the finish of the Product is warranted against material manufacturing defects for a period of one (1) year from the date of Product purchase.

#### **ELECTRONIC FAUCETS AND METERING MECHANICALS WARRANTY**

Electronic and metering faucets mechanicals are warranted against material manufacturing defects for a period of five (5) years from the date of Product purchase.

#### **ELECTRONIC FAUCETS ELECTRONICS AND SOLENOID WARRANTY**

Electronic faucets electronics and solenoid are warranted against material manufacturing defects for a period of three (3) years from the date of Product purchase. This warranty does not cover the life of the battery. The Company offers **NO WARRANTY** for Product batteries.

#### **THIRTY DAY WARRANTY – PALM DEVICES**

Palm devices are reconditioned and are warranted against material manufacturing defects for a period of thirty days from the date of device purchase. The Company offers **NO WARRANTY** for batteries, software (on a CD or from a website), damage the Palm device or software allegedly causes to any system, set-up instructions, adaptors, or other equipment used with the device.

#### **OTHER WARRANTIES**

All other Products not covered above are warranted against material manufacturing defects for a period of one (1) year from the date of Product purchase.

## Limited Warranty

### WHAT THIS WARRANTY DOES NOT COVER

The Company will not be liable for any labor, transportation or consequential expenses not specifically stated above. There is **NO WARRANTY** in cases of damage in transit, negligence, abuse, abnormal usage, misuse, accidents, normal wear and tear, damage due to environmental or natural elements, failure to follow the Company's instructions, unauthorized repair, incorrectly performed maintenance or repair, improper installation or storage or use of acidic, abrasive cleaning materials. In order for this Warranty to apply, Buyer must retain and provide to the Company receipts showing date of Product purchase and documenting proper maintenance. Any oral or written description of the Products is for the sole purpose of identifying the Products and shall not be construed as an express warranty. **THE COMPANY SHALL NOT BE LIABLE TO BUYER, OR TO ANYONE CLAIMING UNDER BUYER, FOR ANY OTHER OBLIGATIONS OR LIABILITIES, INCLUDING, BUT NOT LIMITED TO, OBLIGATIONS OR LIABILITIES ARISING OUT OF BREACH OF CONTRACT OR WARRANTY, NEGLIGENCE OR OTHER TORT OR ANY THEORY OF STRICT LIABILITY, WITH RESPECT TO THE PRODUCTS OR THE COMPANY'S ACTS OR OMISSIONS OR OTHERWISE. THE COMPANY AND BUYER AGREE THAT THE EXPRESS WARRANTIES DESCRIBED ABOVE ARE EXCLUSIVE AND IN LIEU OF ALL OTHER WARRANTIES. ALL OTHER EXPRESS WARRANTIES ARE DISCLAIMED. FOR COMMERCIAL PRODUCTS, ALL WARRANTIES IMPLIED BY LAW, INCLUDING WITHOUT LIMITATION THE IMPLIED WARRANTIES OF MERCHANTABILITY AND FITNESS FOR A PARTICULAR PURPOSE, ARE DISCLAIMED. FOR CONSUMER PRODUCTS, WARRANTIES IMPLIED BY LAW, INCLUDING THOSE OF MERCHANTABILITY AND FITNESS FOR A PARTICULAR PURPOSE, ARE EXPRESSLY LIMITED TO THE PERIOD OF THE EXPRESS LIMITED WARRANTY STATED ABOVE FOR THE RELEVANT PRODUCT.** Some States do not allow limitations on how long an implied warranty lasts, so the above limitation may not apply to you. Any assistance the Company provides to or procures for Buyer outside the terms, limitations or exclusions of this warranty will not constitute a waiver of the terms, limitations or exclusions of this limited warranty, nor will such assistance extend or revive the warranty. The Company will not reimburse Buyer for any expenses incurred by Buyer in repairing, correcting or replacing any defective Products, except for expenses incurred with the Company's prior written permission.

### HOW TO GET SERVICE

For complete warranty details, or to provide notice of a warranty claim or request warranty service, contact your Chicago Faucets Sales Representative or The Chicago Faucet Company, Customer Service, 2100 S. Clearwater Drive, Des Plaines, Illinois 60018 or 847-803-5000. As the Company's sole and exclusive obligation under this warranty (and Buyer's sole and exclusive remedy), upon prompt written notice of breach from Buyer during the warranty period, the Company will either replace or repair the defective Product or refund the wholesale purchase price, at its option, if an inspection by the Company discloses defects in material or workmanship covered by this warranty. These warranty provisions do not cover the battery shipped with the electronic products.

### LIMITATION ON DAMAGES

**IN NO EVENT SHALL THE COMPANY BE LIABLE FOR INCIDENTAL, CONSEQUENTIAL, INDIRECT OR SPECIAL DAMAGES. WITHOUT LIMITING THE FOREGOING, THE COMPANY SHALL NOT BE LIABLE FOR ANY DAMAGE A PALM DEVICE OR ANY SOFTWARE OR RELATED EQUIPMENT ALLEGEDLY CAUSES TO A SYSTEM OR OTHERWISE. THE COMPANY'S AGGREGATE LIABILITY WITH RESPECT TO A DEFECTIVE PRODUCT AND THIS CONTRACT SHALL BE LIMITED TO AN AMOUNT EQUAL TO THE MONIES PAID TO THE COMPANY FOR THAT DEFECTIVE PRODUCT.**

Some states do not allow the exclusion or limitation of incidental or consequential damages, so the above limitation or exclusion may not apply to you.

### HOW DOES STATE LAW APPLY?

This warranty gives you specific legal rights, and you may also have other rights which vary from state to state.

#### Restrictions Apply.

Palm is trademarked by Palm Inc. and is not affiliated with The Chicago Faucet Company.

## Product Specifications

### I. GENERAL

- A. The manufacturer shall be certified to ISO 9001 (Quality Management Systems) and ISO 14001 (Environmental Management Systems) standards.
- B. All laboratory fittings and safety equipment shall be of one manufacturer to facilitate ease of future maintenance and availability of repair parts.
- C. All fittings shall be factory assembled unless otherwise specified. All fittings will be factory tested as stated below.
- D. All water fittings described as Single Water Inlet Fittings or Combination Fittings (hot and cold water) shall be constructed with low lead brass as delineated below.
- E. Four arm cross handles with indexing will be provided unless otherwise specified. Standard industry color coding will be used to identify the media, as follows:

Service	Color	Symbol
Cold Water	Green	CW
Hot Water	Red	HW
Gas	Blue	GAS
Air	Orange	AIR
Vacuum	Yellow	VAC
Nitrogen	Brown	N
Steam	Black	STM
Deionized Water	White	DI

### II. FINISH

All water and gas fittings shall have either a polished chrome or satin antimicrobial finish:

#### A. Polished Chrome

All exposed surfaces shall be highly polished prior to electroplating; which will consist of one layer of durable bright nickel plate followed by one layer of durable chromium plate.

#### B. Satin Antimicrobial

All exposed surfaces shall be highly polished prior to electroplating, which will consist of one layer of durable bright nickel plate followed by one layer of durable chromium plate. An antimicrobial, silver ion based epoxy-polyester powder coat will be baked on to all exposed surfaces at a thickness of 2 mils.

#### C. Chemical Resistance – Satin Antimicrobial

##### Direct application test (1):

The reagents are directly applied to a flat panel coated surface, covered and kept wet for a period of one hour, at 77°F. The samples shall not rupture, though slight discoloration is permissible.

##### Direct application test (2):

Subject coated sample to the direct action of the listed reagents and solvents at a temperature of 77°F, dropping from a burette at the rate of 60 drops per minute for ten minutes. The samples shall not rupture, though slight discoloration or temporary softening is permissible.

Acetate, Amyl (1)(2)  
 Acetate, Ethyl (1)(2)  
 Acetic Acid, 98% (1)(2)  
 Acetone (1)(2)  
 Acid Dichromate, 5% (1)(2)  
 Alcohol, Butyl (1)(2)  
 Alcohol, Ethyl (1)(2)  
 Alcohol, Methyl (1)(2)  
 Ammonium Hydroxide, 28% (1)(2)  
 Chloroform (2)  
 Cresol (2)  
 Dichlor Acetic Acid (2)  
 Dimethylformamide (2)  
 Ethyl Ether (1)(2)  
 Formaldehyde, 37% (1)(2)  
 Formic Acid, 90% (1)(2)  
 Furfural (1)(2)  
 Gasoline (1)(2)  
 Hydrochloric Acid, 37% (1)(2)  
 Hydrofluoric Acid, 48% (1)(2)  
 Hydrogen Peroxide, 3% (1)(2)  
 Iodine, Tincture of (1)(2)  
 Methyl Ethyl Ketone (2)  
 Methylene Chloride (2)  
 Mono Chlorobenzene (2)  
 Nitric Acid, 20% (1)(2)  
 Nitric Acid, 30% (1)(2)  
 Nitric Acid, 70% (1)(2)  
 Phenol, 90% (2)  
 Phosphoric Acid, 85% (1)(2)  
 Silver Nitrate, Saturated (1)(2)  
 Sodium Hydroxide, 10% (1)(2)  
 Sodium Hydroxide, 20% (1)(2)  
 Sodium Hydroxide, 40% (1)(2)  
 Sodium Hydroxide, Flake (1)(2)  
 Sodium Sulfide, Saturated (1)(2)  
 Sulfuric Acid, 33% (1)(2)  
 Sulfuric Acid, 77% (1)(2)  
 Sulfuric Acid, 96% (2)  
 Sulfuric Acid, 77% & Nitric Acid, 70% (2)  
 Trichloroethylene (1)(2)  
 Xylene (1)(2)  
 Zinc Chloride, Saturated (1)(2)



## Product Specifications

### Fume Test:

Suspend coated samples in a container at least 6 cubic foot capacity, approximately 12" above open beakers, each containing 100 cc of 70% nitric acid, 94% sulfuric acid and 35% hydrochloric acid, respectively. After exposure to these fumes for 150 hours, the finish on the samples shall show no discoloration, disintegration or other defects.

### III. WATER FAUCETS & VALVES

#### A. Water Fittings – Low Lead

The metal alloys in contact with water shall not exceed 8% lead content. All faucets described as Single Water Inlet Fittings or Combination Fittings (hot and cold water) shall be NSF 61, Section 9 compliant and certified to CSA B125.

#### B. Cartridges

All parts in compression cartridges that are subject to wear shall be renewable. Cartridge types shall be interchangeable; allowing conversion without removing the faucet. Cartridge types shall include: slow compression, quarter turn compression, self-closing, adjustable controlled low flow, internal check, ceramic quarter turn and steam. All cartridge stems will have a tapered square broach to facilitate handle removal.

#### C. Gooseneck Spouts

All spouts will be field convertible from rigid to swing unless otherwise specified. The inlet side of the spout will be sealed with double o-rings. The outlet side of the spout will be equipped with a 10 serration hose nozzle mounted into a 3/8" NPSM female thread. The spouts on fittings designated as vandal resistant (VR) shall be cemented in the rigid position at the base and cemented at the hose nozzle.

#### D. Vacuum Breaker Spouts

Atmospheric vacuum breaker bodies shall be constructed of cast brass. The spout assemblies shall be cemented to the body and all internal parts shall be renewable. Vacuum breakers shall be certified under ASSE 1001.

#### E. Testing

All water and steam valves shall be factory tested to 80 PSI and be certified by the Canadian Standards Association under standard CSA B125.1, ASME A112.18.1.

### IV. AIR, GAS AND VACUUM FITTINGS

#### A. Turrets

Turrets shall be constructed of either forged or cast brass with shanks assembled, unless otherwise specified. Inlets and outlets shall be 3/8" NPT. Panel mounted turret with spouts shall be NSF 61, Section 9 compliant.

#### B. Ball Valves

All ball valves shall be configured with a floating stainless steel ball with two Teflon™ seats. Service applications to include water, natural gas, air, vacuum, nitrogen, helium, argon, propane, hydrogen, and other common lab gasses. Ball valves will be ADA compliant and have a maximum pressure rating of 125 PSI.

#### C. Needle Valves

Needle valves shall be constructed with a self-centering floating stainless steel cone that seats in a renewable brass sleeve with integral seat. Handle resistance will be adjustable at the external packing nut which compresses a Teflon™ die-formed packing ring. All parts shall be serviceable without removing the fixture.

#### D. Testing

All valves where used in the supply of gaseous substances shall be tested after assembly for leaks at the body surface, inlet, outlet, stem and cap. The entire ball valve shall be submersed under water for 15 seconds while pressurized to 40 PSI of Nitrogen and observed for leakage. The entire needle valve will be submersed under water for 15 seconds while pressurized to 80 PSI of Nitrogen and observed for leakage.

### V. PURE WATER FITTINGS

#### A. Distilled Water

All fittings designated as suitable for distilled water shall be of all brass construction. All interior surfaces that come in contact with water shall be tin lined.

#### B. Deionized Water

All fittings designated as suitable for deionized water shall be constructed with PVC or an exterior brass shell. The interior of ultra pure water valves shall be constructed using polypropylene with polytetrafluoroethylene (PTFE) seat.

### VI. LABORATORY ACCESSORIES

#### A. Electric Pedestal Boxes

Cast aluminum pedestal boxes shall be supplied with brushed finish. Boxes will be shipped with all mounting hardware and grounding screw. All fixtures shall be listed by the Underwriters Laboratory (UL) under standard UL514A.

#### B. Safety Equipment

Eye wash, eye/face wash and drench showers shall be provided. All safety equipment will be compliant with ANSI Z358.1.

## Index

Model Number	Page
828-ACP .....	16
828-ASAM .....	7
829-ACP .....	16
838-CP .....	16
839-CP .....	16
869-BLHPVC .....	17
869-BPVC .....	17
870-BPVC .....	17
900-CP .....	19
901-BAGVCP .....	25
909-AGVCP .....	25
909-AIRCP .....	25
909-CAGCP .....	25
909-CGASCP .....	25
909-GASCP .....	26
909-VACCP .....	26
913-AGVCP .....	18
913-AGVSAM .....	7
913-LHAGVSAM .....	7
914-CP .....	18
914-SAM .....	7
915-CP .....	18
927-317CP .....	10
927-CP .....	10
927-SAM .....	6
927-VPPCP .....	10
928-317CP .....	11
928-317SAM .....	6
928-369CP .....	11
928-CP .....	11
928-GN8BVB7CP .....	11
928-VR317CP .....	11
928-VR369CP .....	11
928-VRCP .....	11
928-VRE3-2CP .....	11
928-VRLHCP .....	11
928-VRSAM .....	6
929-317CP .....	12
929-CP .....	12
929-SAM .....	6
930-317CP .....	12
930-317SAM .....	6
930-369CP .....	12
930-CP .....	12
930-GN8BVB7-317CP .....	12
930-GN8BVB7CP .....	12
930-SAM .....	7
930-VR317CP .....	12
930-VR317SAM .....	7
930-VR369CP .....	12
930-VRCP .....	13
930-VRSAM .....	13
930-XKCP .....	13
931-L12CP .....	13
931-VBE3-2CP .....	13
931-VBE7CP .....	13
932-VBE7WSCP .....	14
932-WSCP .....	14
933-CP .....	14
933-WSCP .....	14
934-CP .....	14
934-WSCP .....	14
937-CHAGVCP .....	25
937-CP .....	26
937-STCP .....	26
937-WHAGVCP .....	25
938-CP .....	15
938-WSCP .....	15
940-CP .....	15
940-VBE7WSLCP .....	15
940-WSLCP .....	15
941-CP .....	13
941-VBE7CP .....	13
942-CP .....	15

Model Number	Page
942-WSLCP .....	15
943-317CP .....	15
943-CP .....	15
943-WSLCP .....	16
946-CP .....	13
947-317CP .....	13
947-369CP .....	14
947-CP .....	14
954-CHAGVCP .....	25
954-CP .....	25
962-VOACP .....	18
962-VOCP .....	18
962-VOGAAGVCP .....	18
962-VOGAGVCP .....	18
962-VOSAM .....	8
962-VOSCP .....	18
969-217XLHCTF .....	17
969-CTF .....	17
969-SAM .....	7
970-CTF .....	17
971-CTF .....	17
972-CTF .....	17
980-909-957-3KAGVCP .....	21
980-909AGVCP .....	21
980-909CAGCP .....	21
980-937CHAGVCP .....	21
980-CP .....	19
980-VP7CP .....	19
980-VR909CAGCP .....	21
980-VR909CAGSAM .....	8
980-WS909AGVCP .....	21
980-WS909CAGCP .....	21
980-WSCP .....	20
980-WSE7TCP .....	20
980-WSGN2BE7SAM .....	9
980-WSGN2BVB7CP .....	24
980-WSGN2BVB7SAM .....	9
980-WSV909AGVSAM .....	8
980-WSV909CAGSAM .....	8
980-WSV937CHAGVSAM .....	8
981-901B957-3KAGVCP .....	21
981-909-957-3KAGVCP .....	22
981-909AGVCP .....	22
981-909CAGCP .....	22
981-937CHAGVCP .....	22
981-CP .....	20
981-VR909AGVCP .....	22
981-VR909CAGCP .....	22
981-VR909CAGSAM .....	8
981-WS909AGVCP .....	22
981-WS909CAGCP .....	22
981-WS937CHAGVCP .....	22
981-WSCP .....	20
981-WSV909AGVSAM .....	8
982-909-957-3KAGVCP .....	23
982-909AGVCP .....	23
982-909CAGCP .....	23
982-937CHAGVCP .....	23
982-CP .....	20
982-DS909AGVCP .....	23
982-DSVR909CAGCP .....	23
982-VP909CAGCP .....	23
982-VP7CP .....	20
982-VR909AGVCP .....	23
982-VR909CAGCP .....	23
982-VR909CAGSAM .....	9
982-WS909AGVCP .....	24
982-WS909CAGCP .....	24
982-WSCP .....	20
982-WSV909AGVSAM .....	9
983-909AGVCP .....	24
983-WSCP .....	20
984-CP .....	20
984-VR909CAGCP .....	24

Model Number	Page
984-WSCP .....	21
985-AWSGN2BVB7CP .....	24
985-BCP .....	24
985-HRCP .....	24
986-909AGVCP .....	27
986-937CHAGVCP .....	27
986-CP .....	26
986-E7TCP .....	18
986-E7XTCP .....	19
986-FCP .....	26
986-FE7XTCP .....	19
986-WSE7XTSAM .....	9
986-WSV909AGVCP .....	27
986-WSV909AGVSAM .....	9
986-WSV937CHAGVCP .....	27
986-WSV937CHAGVSAM .....	9
987-909AGVCP .....	27
987-909CAGCP .....	27
987-937CHAGVCP .....	27
987-CP .....	26
987-FCP .....	26
988-LWSCP .....	26
988-WSCP .....	27
988-WSGN2BVB7CP .....	19
997-CP .....	24
1300-CP .....	16
1300-MCP .....	16
1301-CP .....	10
1301-GN2BVB7-369CP .....	10
1301-GN2BVB7CP .....	10
1301-WSVGN2BVB7SAM .....	6
1301-WSVSAM .....	6
1305-CP .....	16
1305-PLCP .....	16
1310-ABAF .....	28
1311-ABAF .....	28
1312-ABAF .....	28
1313-ABAF .....	28
1322-205AGVCP .....	19
1322-AGVCP .....	19
1322-AGVSAM .....	8
1323-CP .....	19
1323-SAM .....	8
1332-CP .....	10
1332-E2E7CP .....	10
1332-E2E7SAM .....	6
1332-SAM .....	6
1334-CP .....	14
8001-NF .....	30
8003-NF .....	30
8004-LHNF .....	30
8004-RHNF .....	30
8008-NF .....	30
8010-NF .....	30
8011-NF .....	30
8100-NF .....	30
8101-NF .....	30
8202-NF .....	31
8205-NF .....	31
8206-NF .....	31
8305-NF .....	31
8310-NF .....	31
9400-NF .....	31
9901-NF .....	28
9902-NF .....	28
9903-NF .....	28
9904-NF .....	28
9905-NF .....	28
9906-NF .....	29
9907-NF .....	29
9911-NF .....	29
9912-NF .....	29
9913-NF .....	29

## Notes



Chicago Faucets, a member of the Geberit Group, is the leading brand of commercial faucets and fittings in the United States, offering a complete range of products for schools, laboratories, hospitals, office buildings, food service, airports, and sports facilities. Whatever your requirements may be, Chicago Faucets offers standard and made-to-order products that are designed to meet any commercial application.

The Chicago Faucet Company  
2100 South Clearwater Drive  
Des Plaines, IL 60018  
Phone: 847/803-5000  
Fax: 847/803-5454  
Technical: 800/832-8783  
[www.chicagofaucets.com](http://www.chicagofaucets.com)